

Schémas d'applications pour le collier CFS-C P



Applications pour eau potable en dalle rigide épaisseur 150 mm

- Tube Al composite avec isolant type Armaflex POT-RF-AL-0076/77
- Tube plastique PE POT-RF-PP-0108/109
- Tube plastique PP POT-RF-PP-0114-120
- Tube plastique PVC POT-RF-PP-0121

*) Tous les schémas sont également disponibles sur demande en format DWG pour faciliter l'insertion sur des plans.



CONTENTS

Al composite pipe in a rigid floor

ID

POT-RF-AL-0076

FIRESTOP COLLAR

0076_01

REV

00

No scale

All units are in millimetres

Fire Rating EI 180 U/C

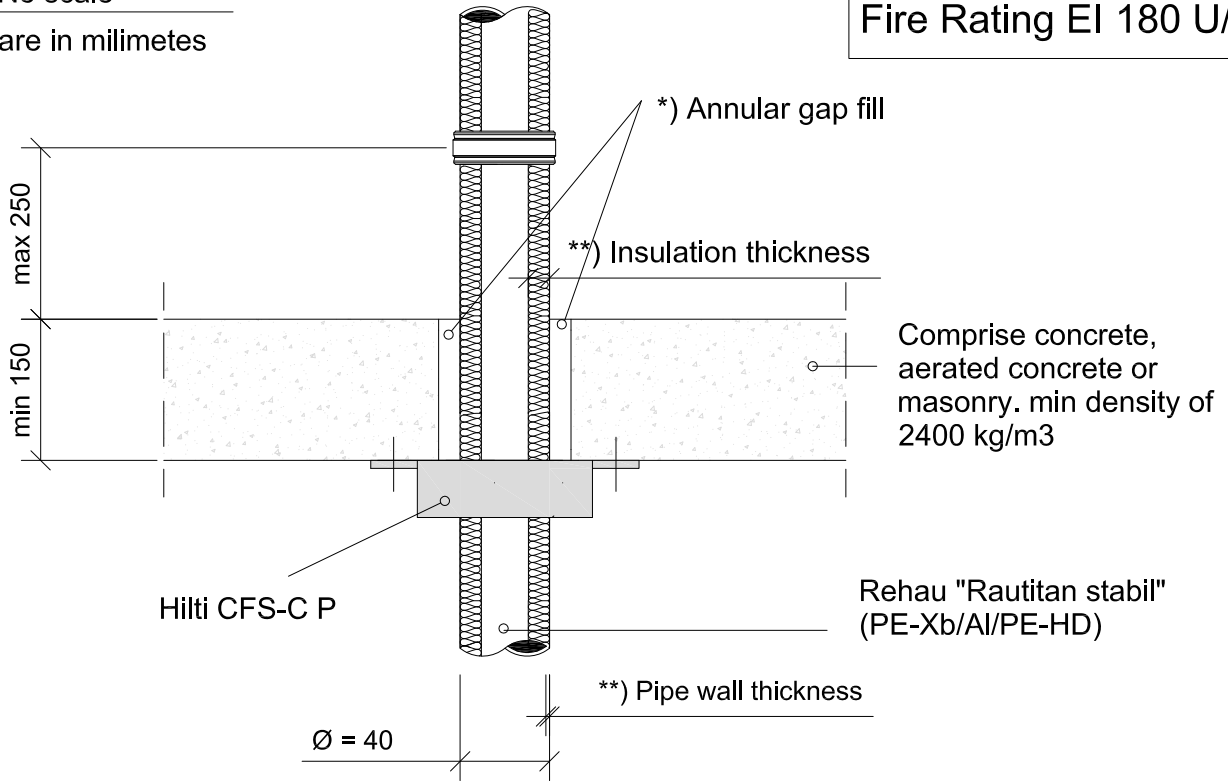

*) Annular gap fill material

Hilti Firestop Acrylic Sealant CFS-S ACR on both sides with depth > 10 mm from the surface of the wall, backfilled with mineral wool min 60 kg/m³.

Gypsum plaster or cementitious mortar over the entire thickness of the floor.

- Approval ETA-14/0404 of 31/01/2013
- Reaction to fire acc EN 13501-1
- Fire resistance test acc 1366-3
- Installation according to Hilti instructions

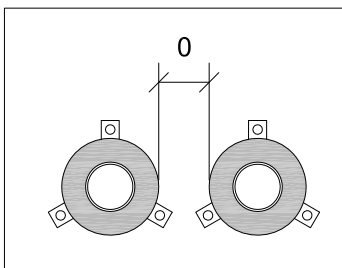

Zero distance between annular gap

**) Pipe wall and insulation thickness - Armaflex AF, continued sustained or local sustained (LD>250 mm)

| Pipe Ø | Pipe Wall Thickness | Insulation Thickness | Collar Size |
|--------|---------------------|----------------------|---------------|
| 40 | 6.0 | 9.0 | CFS-C P 63/2" |



CONTENTS

Al composite pipe in a rigid floor

ID

POT-RF-AL-0077

FIRESTOP COLLAR

0077_01

REV

00

No scale

All units are in millimetres

Fire Rating EI 120 U/C

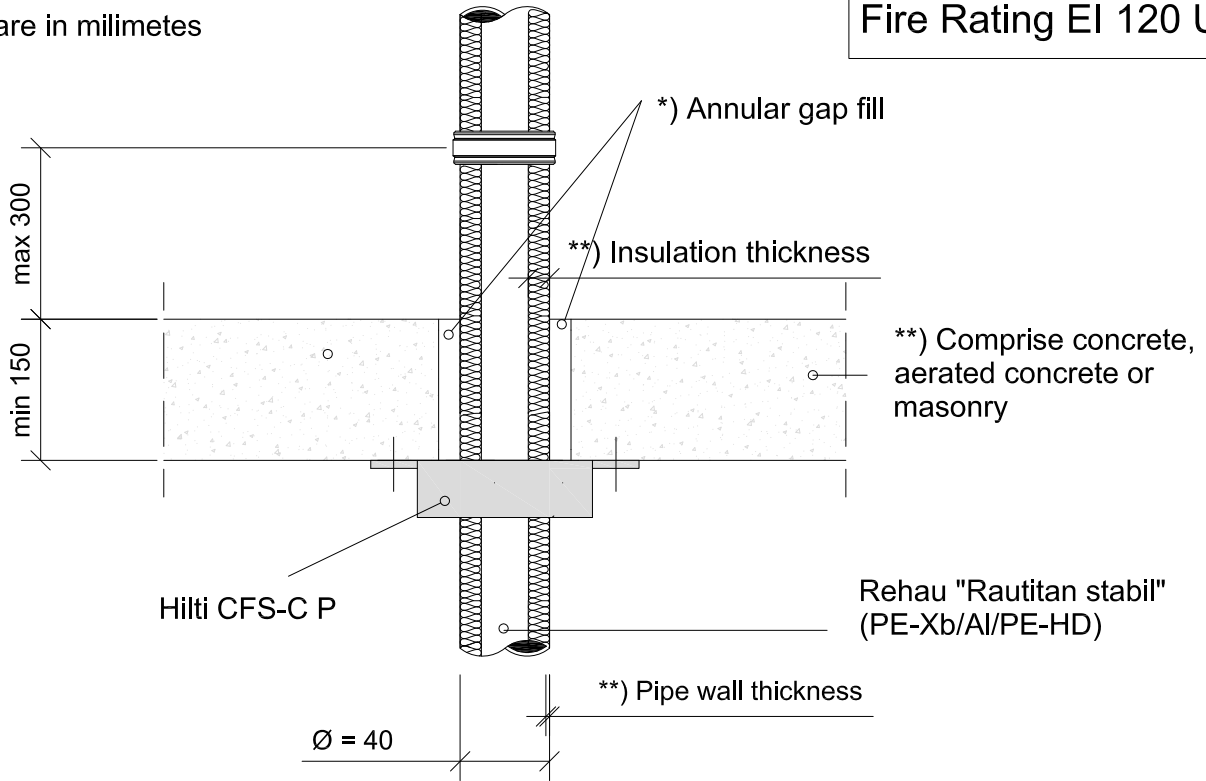

*) Annular gap fill material

Hilti Firestop Acrylic Sealant CFS-S ACR on both sides with depth > 10 mm from the surface of the wall, backfilled with mineral wool min 60 kg/m³.

Gypsum plaster or cementitious mortar over the entire thickness of the floor.

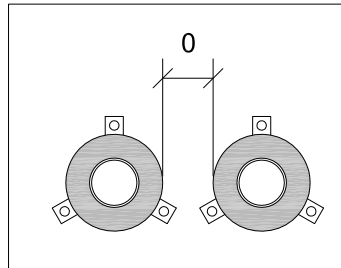

Zero distance between annular gap

- Approval ETA-14/0404 of 31/01/2013
- Reaction to fire acc EN 13501-1
- Fire resistance test acc 1366-3
- Installation according to Hilti instructions

**). Pipe wall and insulation thickness - Armaflex AF, continued sustained or local sustained (LD>250 mm)

| Pipe Ø | Pipe Wall Thickness | Insulation Thickness for $\rho > 2400 \text{ kg/m}^3$ | Insulation Thickness for $\rho > 550 \text{ kg/m}^3$ | Collar Size |
|--------|---------------------|---|--|-------------------------|
| 40 | 6.0 | 9-20.5 | 20.5 | CFS-C P 63/2.0"-75/2.5" |



CONTENTS

Straight plastic pipe in a floor

ID

POT-RF-PP-0108

FIRESTOP COLLAR

0108_01

REV

00

No scale

All units are in millimetres

Fire Rating EI 180 U/C

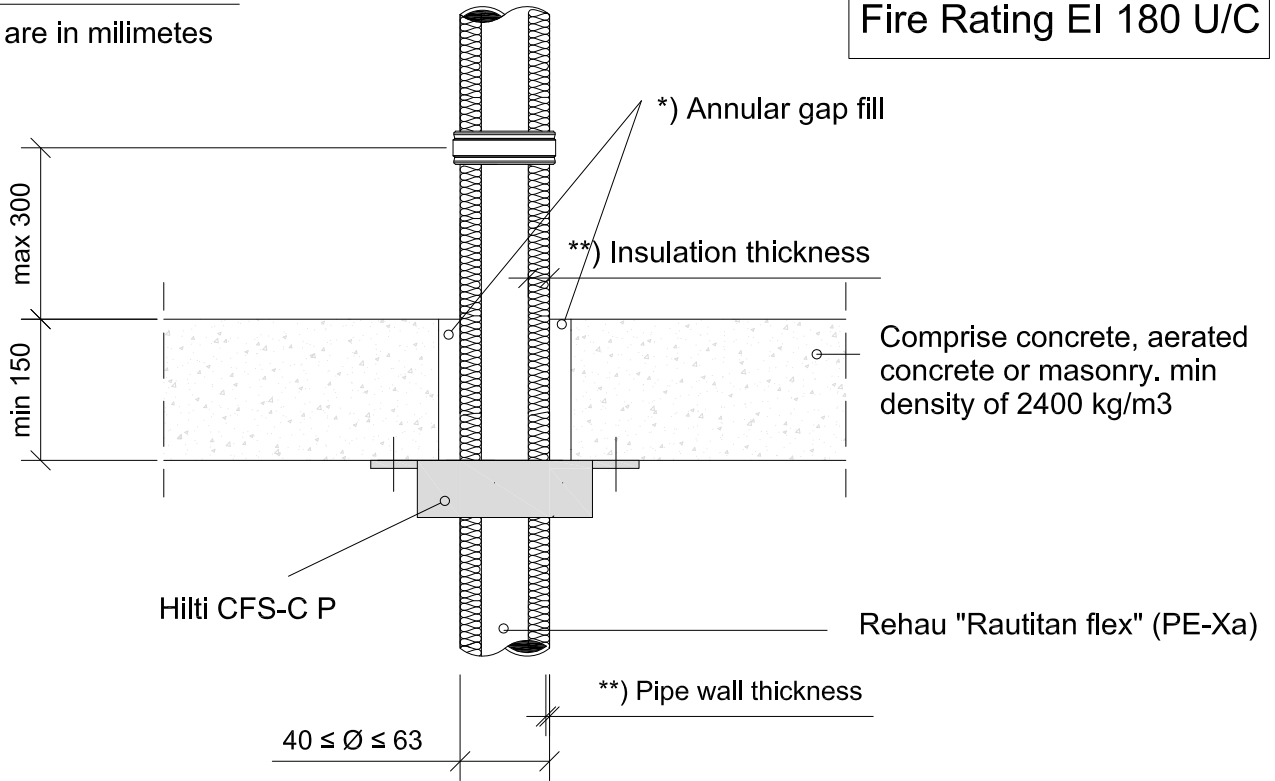

*) Annular gap fill material

Hilti Firestop Acrylic Sealant CFS-S ACR on both sides with depth > 10 mm from the surface of the wall, backfilled with mineral wool min 60 kg/m³.

Gypsum plaster or cementitious mortar over the entire thickness of the floor.

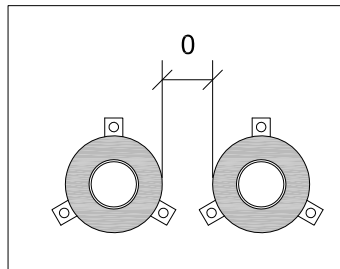

Zero distance between annular gap

- Approval ETA-14/0404 of 31/01/2013
- Reaction to fire acc EN 13501-1
- Fire resistance test acc 1366-3
- Installation according to Hilti instructions

**) Pipe wall and insulation thickness - Armaflex AF, continued sustained or local sustained (LD>250 mm)

| Pipe Ø | Pipe Wall Thickness | Insulation Thickness | Collar Size |
|--------|---------------------|----------------------|-----------------|
| 40 | 6.0 | 9 | CFS-C P 63/2" |
| 50 | 6.9 | 9 | CFS-C P 75/2.5" |
| 63 | 8.6 | 9 | CFS-C P 90/3" |



CONTENTS

Straight plastic pipe in a floor

ID

POT-RF-PP-0109

FIRESTOP COLLAR

0109_01

REV

00

No scale

All units are in millimetres

Fire Rating EI 120 U/C

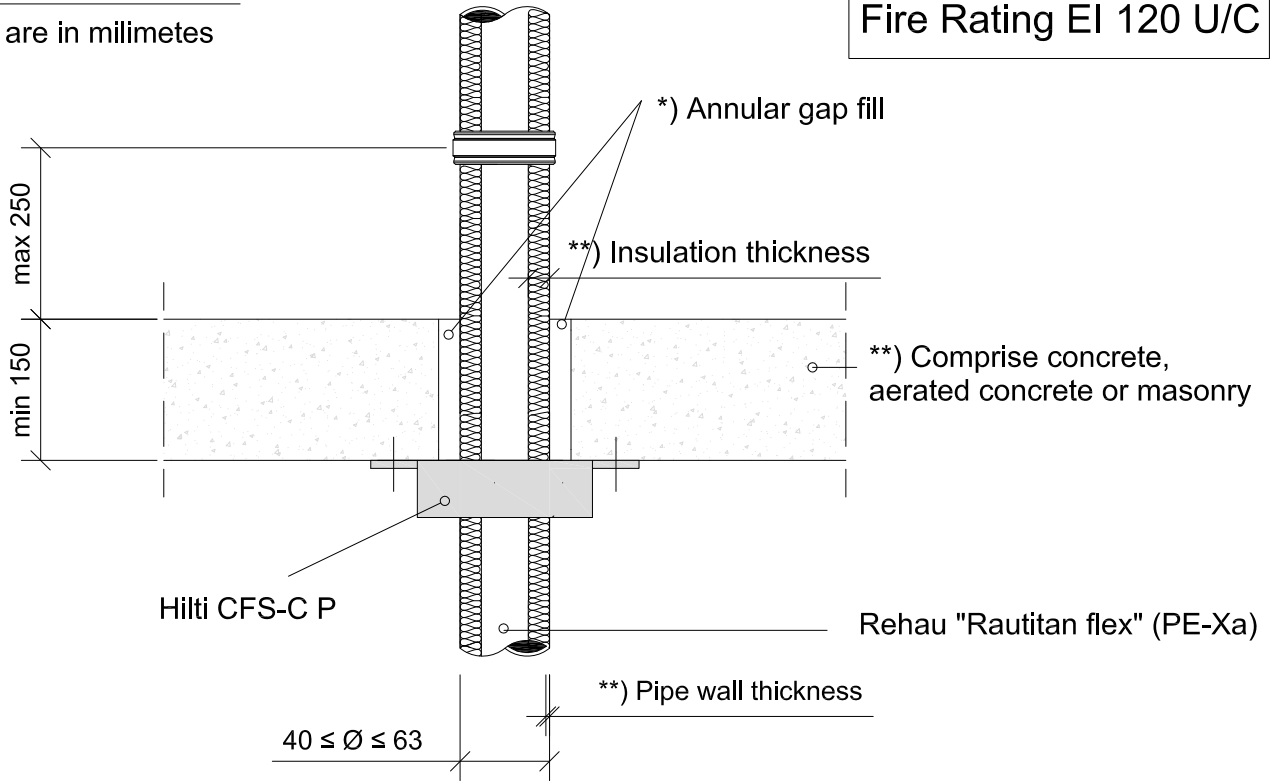

*') Annular gap fill material

Hilti Firestop Acrylic Sealant CFS-S ACR on both sides with depth > 10 mm from the surface of the wall, backfilled with mineral wool min 60 kg/m³.

Gypsum plaster or cementitious mortar over the entire thickness of the floor.

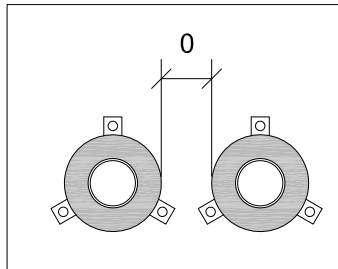

Zero distance between annular gap

- Approval ETA-14/0404 of 31/01/2013
- Reaction to fire acc EN 13501-1
- Fire resistance test acc 1366-3
- Installation according to Hilti instructions

**') Pipe wall and insulation thickness - Armaflex AF, continued sustained or local sustained (LD>250 mm)

| Pipe Ø | Pipe Wall Thickness | Insulation Thickness for $\rho > 2400 \text{ kg/m}^3$ | Insulation Thickness for $\rho > 550 \text{ kg/m}^3$ | Collar Size |
|--------|---------------------|---|--|------------------------|
| 40 | 6.0 | 9-20.5 | 20.5 | CFS-C P 63/2"-75/2.5" |
| 50 | 6.9 | 9-21.0 | 21.0 | CFS-C P 75/2.5"-90/3" |
| 63 | 8.6 | 9-21.5 | 21.5 | CFS-C P 90/3.0"-110/4" |



CONTENTS

Straight plastic pipe in a floor

ID

POT-RF-PP-0114

FIRESTOP COLLAR

0114_01

REV

00

No scale

All units are in millimetres

Fire Rating EI 180 U/U

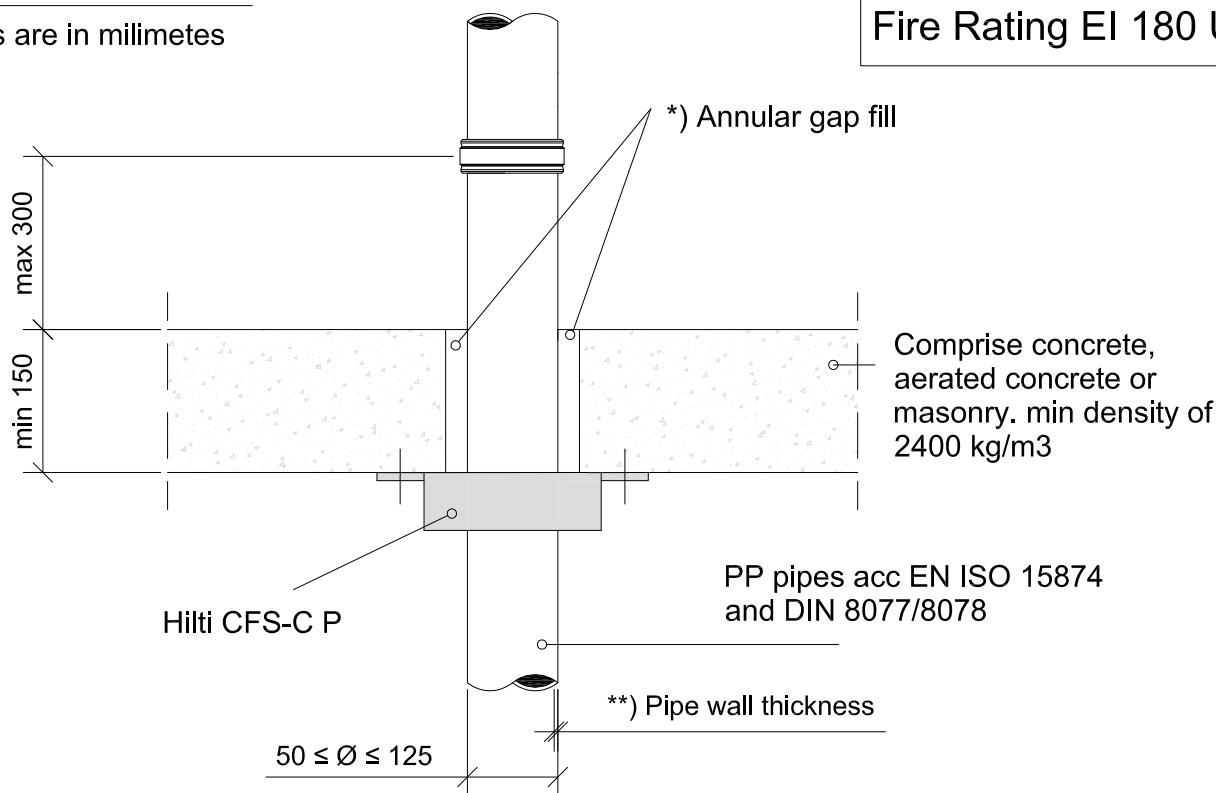

*). Annular gap fill material

Hilti Firestop Acrylic Sealant CFS-S ACR on both sides with depth > 10 mm from the surface of the wall, backfilled with mineral wool min 60 kg/m3.

Gypsum plaster or cementitious mortar over the entire thickness of the floor.

- Approval ETA-14/0404 of 31/01/2013
- Reaction to fire acc EN 13501-1
- Fire resistance test acc 1366-3
- Installation according to Hilti instructions

**). Pipe wall thickness

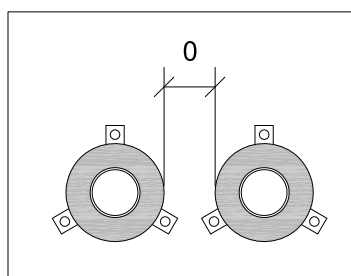

Zero distance between annular gap

| Pipe Ø | Pipe wall thickness | Collar Size |
|--------|---------------------|-----------------|
| 50 | 1.8-2.9 | CFS-C P 50/1.5" |
| 63 | 1.8-5.8 | CFS-C P 63/2" |
| 75 | 1.9-6.8 | CFS-C P 75/2.5" |
| 90 | 2.2-8.2 | CFS-C P 90/3" |
| 110 | 2.7 | CFS-C P 110/4" |
| 125 | 3.1 | CFS-C P 125/5" |

Maximum thickness of sound decoupling: 9 mm



CONTENTS

Straight plastic pipe in a floor

ID

POT-RF-PP-0115

FIRESTOP COLLAR

0115_01

REV

00

No scale

All units are in millimetres

Fire Rating EI 180 U/C

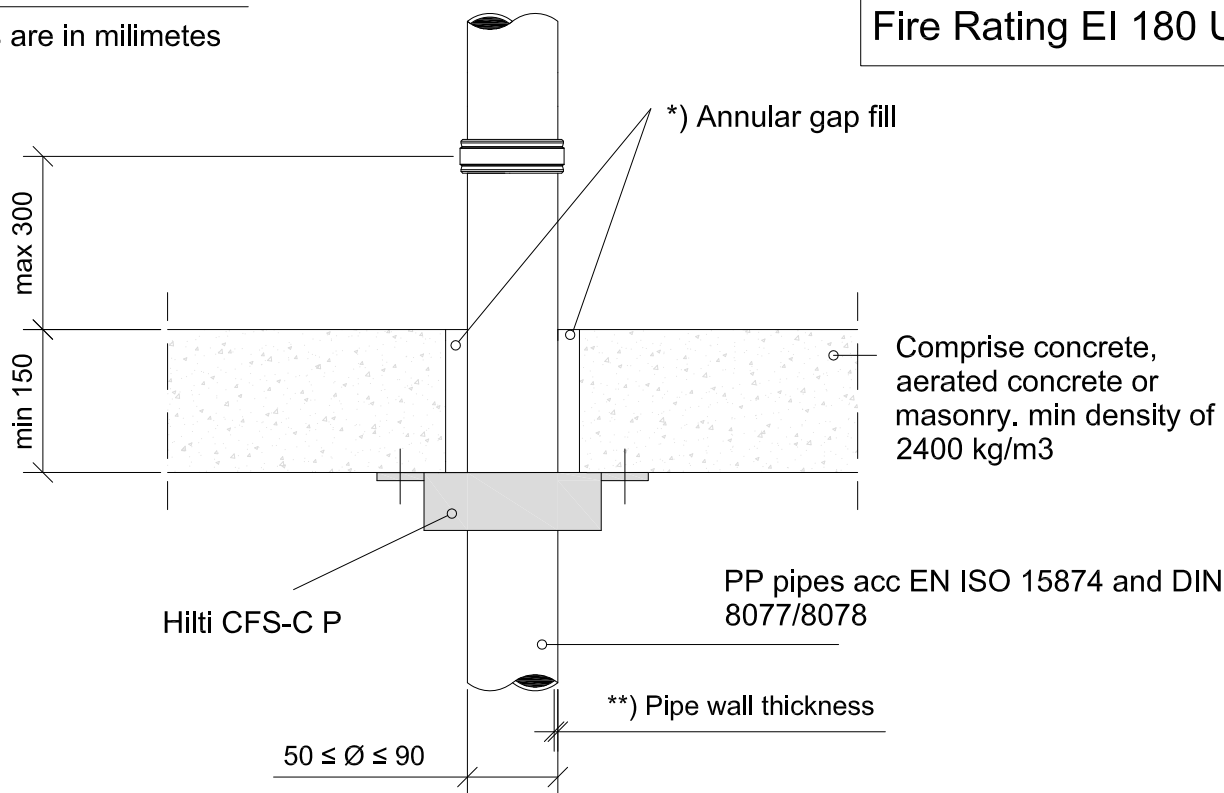

Comprise concrete, aerated concrete or masonry. min density of 2400 kg/m³

PP pipes acc EN ISO 15874 and DIN 8077/8078

Hilti CFS-C P

**). Pipe wall thickness

$50 \leq \varnothing \leq 90$

*). Annular gap fill material

Hilti Firestop Acrylic Sealant CFS-S ACR on both sides with depth > 10 mm from the surface of the wall, backfilled with mineral wool min 60 kg/m³.

Gypsum plaster or cementitious mortar over the entire thickness of the floor.

- Approval ETA-14/0404 of 31/01/2013
- Reaction to fire acc EN 13501-1
- Fire resistance test acc 1366-3
- Installation according to Hilti instructions

**). Pipe wall thickness

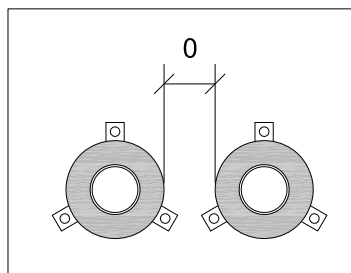

Zero distance between annular gap

| Pipe Ø | Pipe wall thickness | Collar Size |
|--------|---------------------|-----------------|
| 50 | 4.6-8.3 | CFS-C P 50/1.5" |
| 63 | 5.8-10.5 | CFS-C P 63/2" |
| 75 | 6.8 | CFS-C P 75/2.5" |
| 90 | 8.2 | CFS-C P 90/3" |

Maximum thickness of sound decoupling: 9 mm



CONTENTS

Straight plastic pipe in a floor

ID

POT-RF-PP-0116

FIRESTOP COLLAR

0116_01

REV

00

No scale

All units are in millimetres

Fire Rating EI 180 U/C

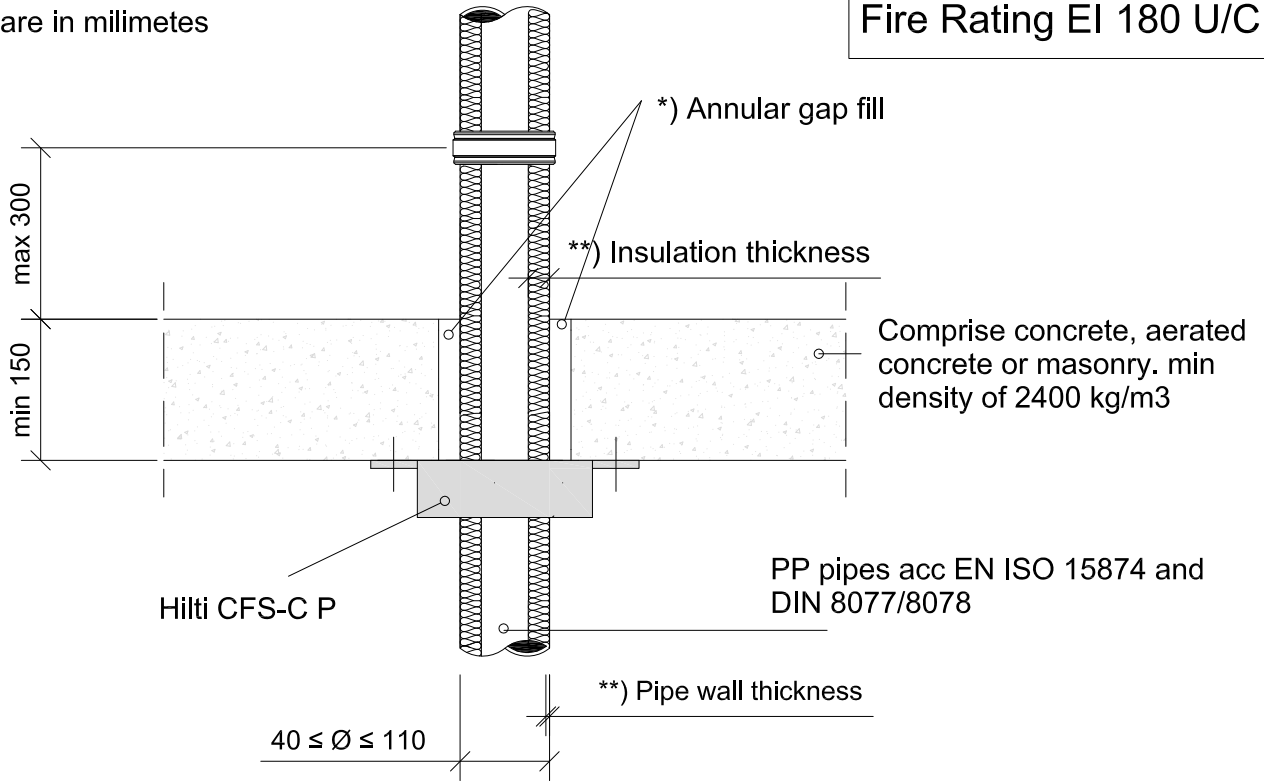

*) Annular gap fill material

Hilti Firestop Acrylic Sealant CFS-S ACR on both sides with depth > 10 mm from the surface of the wall, backfilled with mineral wool min 60 kg/m³.

Gypsum plaster or cementitious mortar over the entire thickness of the floor.

- Approval ETA-14/0404 of 31/01/2013
- Reaction to fire acc EN 13501-1
- Fire resistance test acc 1366-3
- Installation according to Hilti instructions

**) Pipe wall and insulation thickness (Armaflex AF)

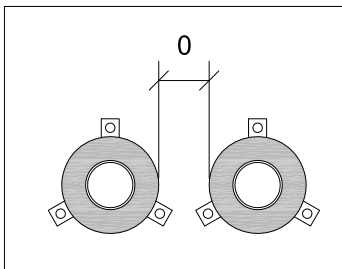

Zero distance between annular gap

| Pipe Ø | Pipe Wall Thickness | Insulation Thickness | Collar Size |
|--------|---------------------|----------------------|-----------------|
| 40 | 3.7-5.5 | 9 | CFS-C P 63/2" |
| 50 | 4.6-6.9 | 9 | CFS-C P 75/2.5" |
| 75 | 6.8-10.3 | 10 | CFS-C P 90/3" |
| 110 | 10-15.1 | 10 | CFS-C P 125/5" |



CONTENTS

Straight plastic pipe in a floor

ID

POT-RF-PP-0117

FIRESTOP COLLAR

0117_01

REV

00

No scale

All units are in millimetres

Fire Rating EI 120 U/U

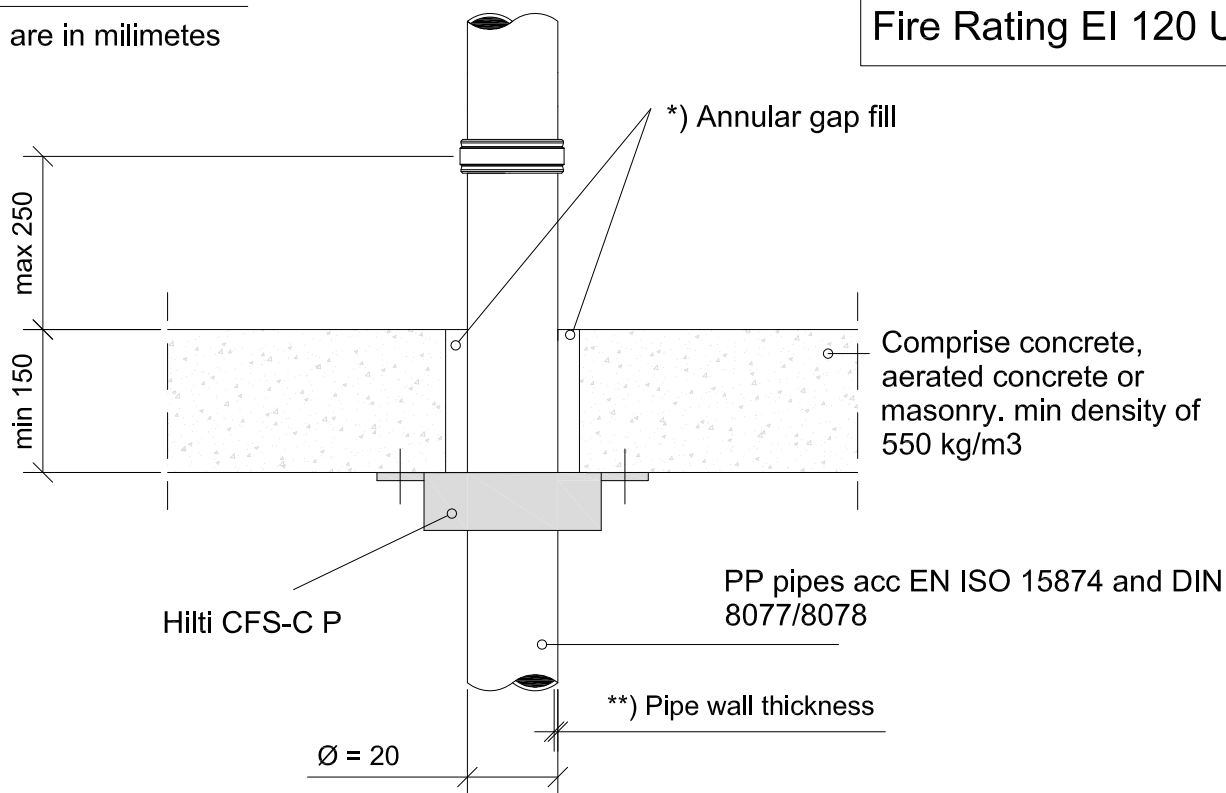

*) Annular gap fill material

Hilti Firestop Acrylic Sealant CFS-S ACR on both sides with depth > 10 mm from the surface of the wall, backfilled with mineral wool min 60 kg/m³.

Gypsum plaster or cementitious mortar over the entire thickness of the floor.

- Approval ETA-14/0404 of 31/01/2013
- Reaction to fire acc EN 13501-1
- Fire resistance test acc 1366-3
- Installation according to Hilti instructions

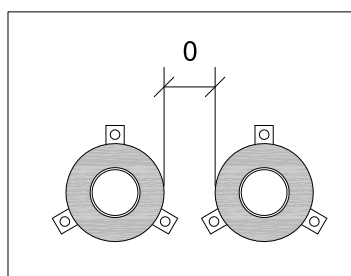

Zero distance between annular gap

**). Pipe wall thickness

| Pipe Ø | Pipe wall thickness | Collar Size |
|--------|---------------------|-----------------|
| 20 | 1.9-3.4 | CFS-C P 50/1.5" |

Maximum thickness of sound decoupling: 9 mm



CONTENTS

Straight plastic pipe in a floor

ID

POT-RF-PP-0118

FIRESTOP COLLAR

0118_01

REV

00

No scale

All units are in millimetres

Fire Rating EI 120 U/C

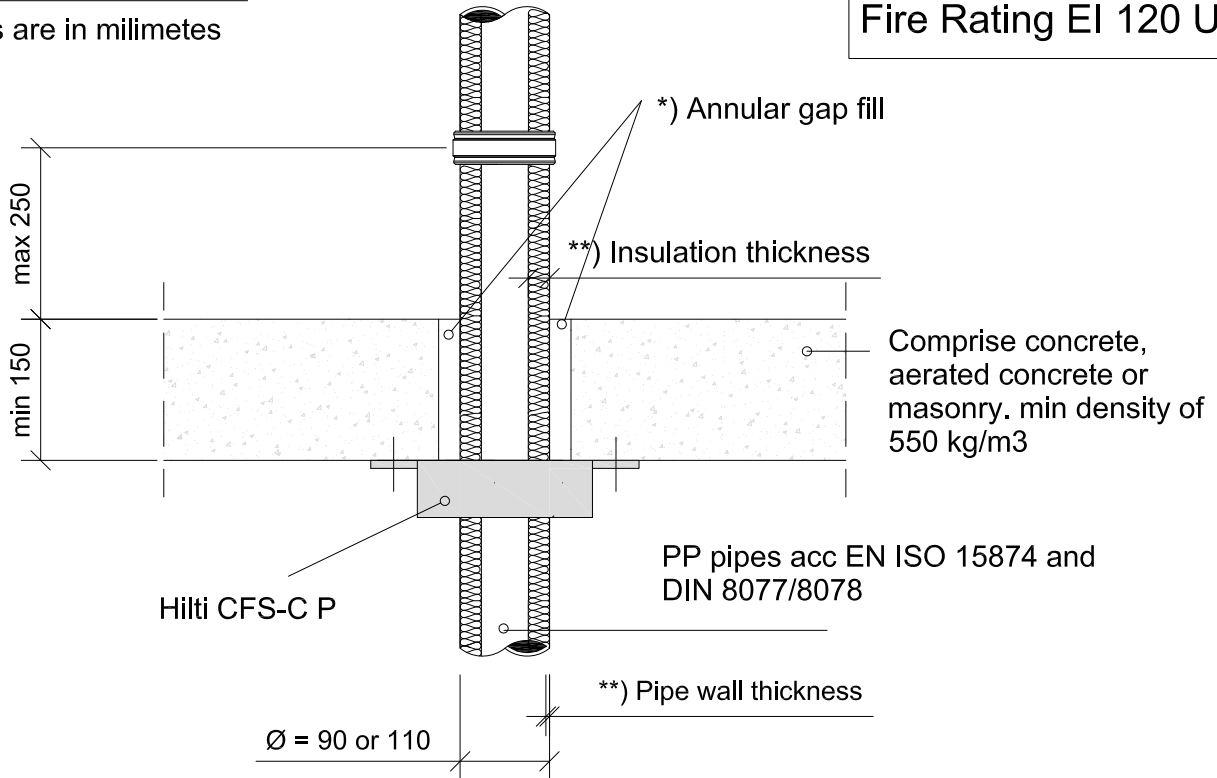

*) Annular gap fill material

Hilti Firestop Acrylic Sealant CFS-S ACR on both sides with depth > 10 mm from the surface of the wall, backfilled with mineral wool min 60 kg/m³.

Gypsum plaster or cementitious mortar over the entire thickness of the floor.

- Approval ETA-14/0404 of 31/01/2013
- Reaction to fire acc EN 13501-1
- Fire resistance test acc 1366-3
- Installation according to Hilti instructions

**) Pipe wall and insulation thickness (Armaflex AF)

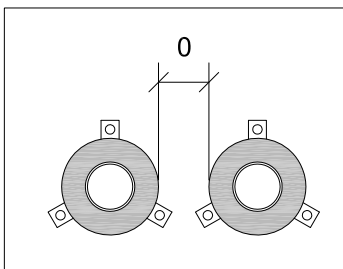

Zero distance between annular gap

| Pipe Ø | Pipe Wall Thickness | Insulation Thickness | Collar Size |
|--------|---------------------|----------------------|----------------|
| 90 | 12.3 | 22.5 | CFS-C P 160/6" |
| 110 | 15.1 | 10.0 | CFS-C P 125/5" |



CONTENTS

Straight plastic pipe in a floor

ID

POT-RF-PP-0119

FIRESTOP COLLAR

0119_01

REV

00

No scale

All units are in milimetres

Fire Rating EI 120 U/C

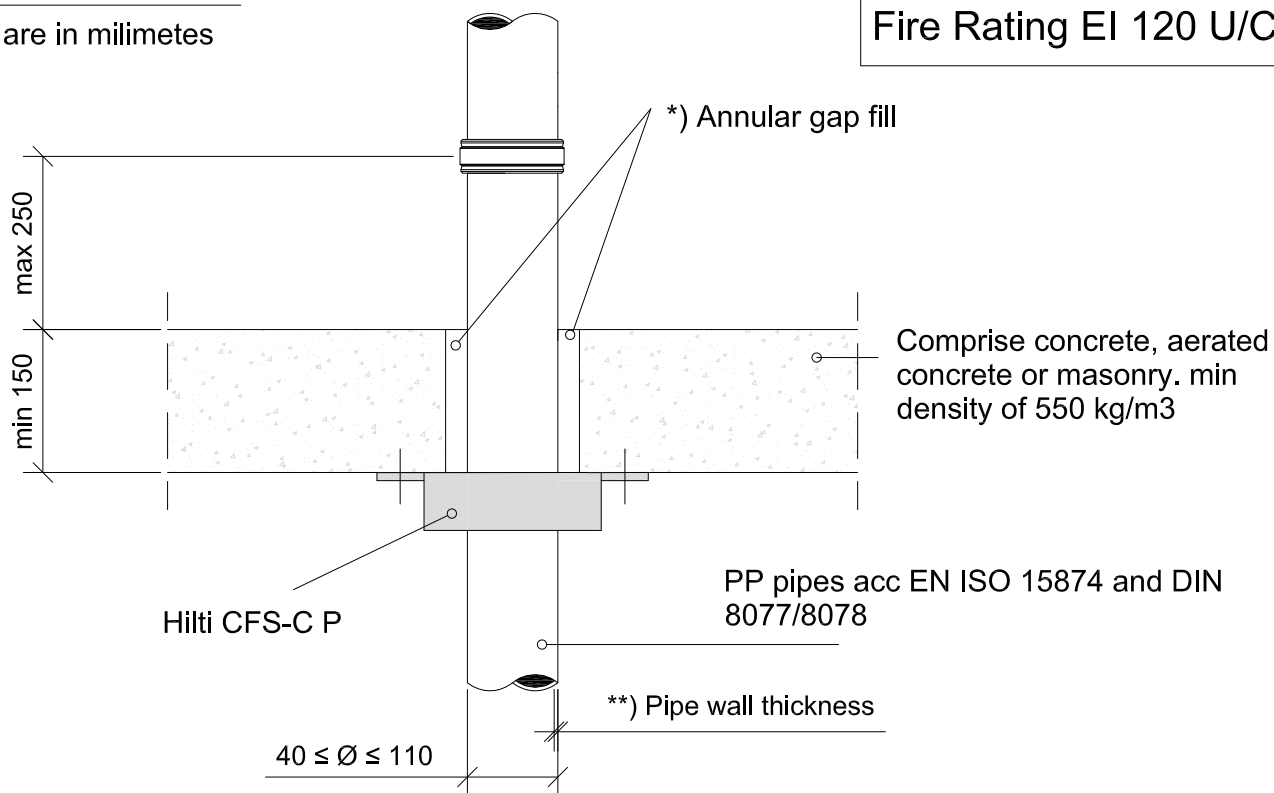

*) Annular gap fill material

Hilti Firestop Acrylic Sealant CFS-S ACR on both sides with depth > 10 mm from the surface of the wall, backfilled with mineral wool min 60 kg/m³.

Gypsum plaster or cementitious mortar over the entire thickness of the floor.

- Approval ETA-14/0404 of 31/01/2013
- Reaction to fire acc EN 13501-1
- Fire resistance test acc 1366-3
- Installation according to Hilti instructions

**) Pipe wall thickness

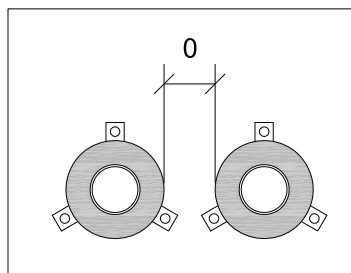

Zero distance between annular gap

| Pipe Ø | Pipe wall thickness | Collar Size |
|--------|---------------------|-----------------|
| 40 | 3.7-5.5 | CFS-C P 50/1.5" |
| 50 | 4.6-6.9 | CFS-C P 50/1.5" |
| 75 | 6.8 | CFS-C P 75/2.5" |
| 90 | 12.3 | CFS-C P 90/3" |
| 110 | 10-15.1 | CFS-C P 110/4" |

Maximum thickness of sound decoupling: 9 mm



CONTENTS

Straight plastic pipe in a floor

ID

POT-RF-PP-0120

FIRESTOP COLLAR

0120_01

REV

00

No scale

All units are in millimetres

Fire Rating EI 120 U/C

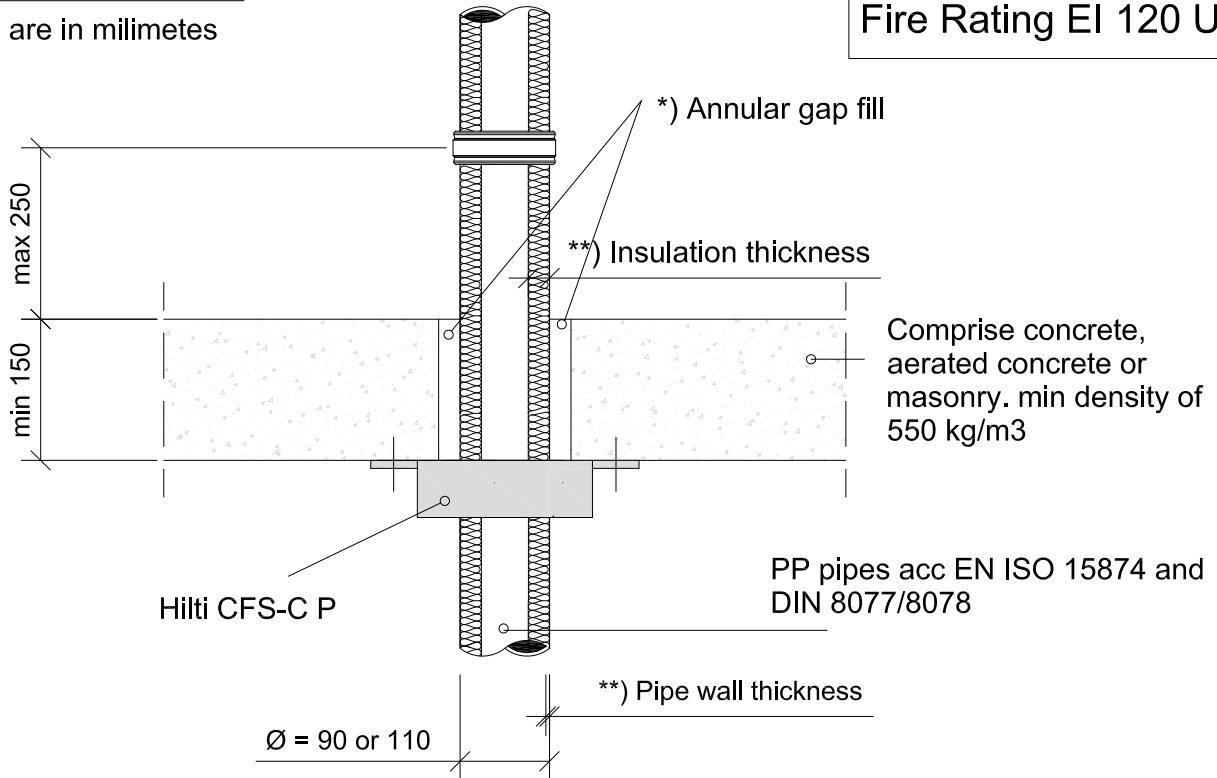

*) Annular gap fill material

Hilti Firestop Acrylic Sealant CFS-S ACR on both sides with depth > 10 mm from the surface of the wall, backfilled with mineral wool min 60 kg/m³.

Gypsum plaster or cementitious mortar over the entire thickness of the floor.

- Approval ETA-14/0404 of 31/01/2013
- Reaction to fire acc EN 13501-1
- Fire resistance test acc 1366-3
- Installation according to Hilti instructions

***) Pipe wall and insulation thickness (Armaflex AF)

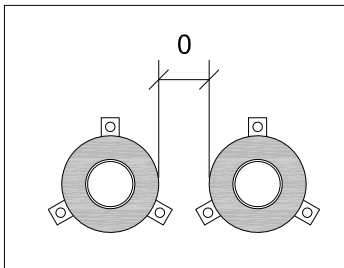

Zero distance between annular gap

| Pipe Ø | Pipe Wall Thickness | Insulation Thickness | Collar Size |
|--------|---------------------|----------------------|----------------|
| 90 | 12.3 | 22.5 | CFS-C P 160/6" |
| 110 | 15.1 | 10.0 | CFS-C P 125/5" |



CONTENTS

Straight plastic pipe in a floor

ID

POT-RF-PP-0121

FIRESTOP COLLAR

0121_01

REV

00

No scale

All units are in millimetres

Fire Rating EI 180 U/C

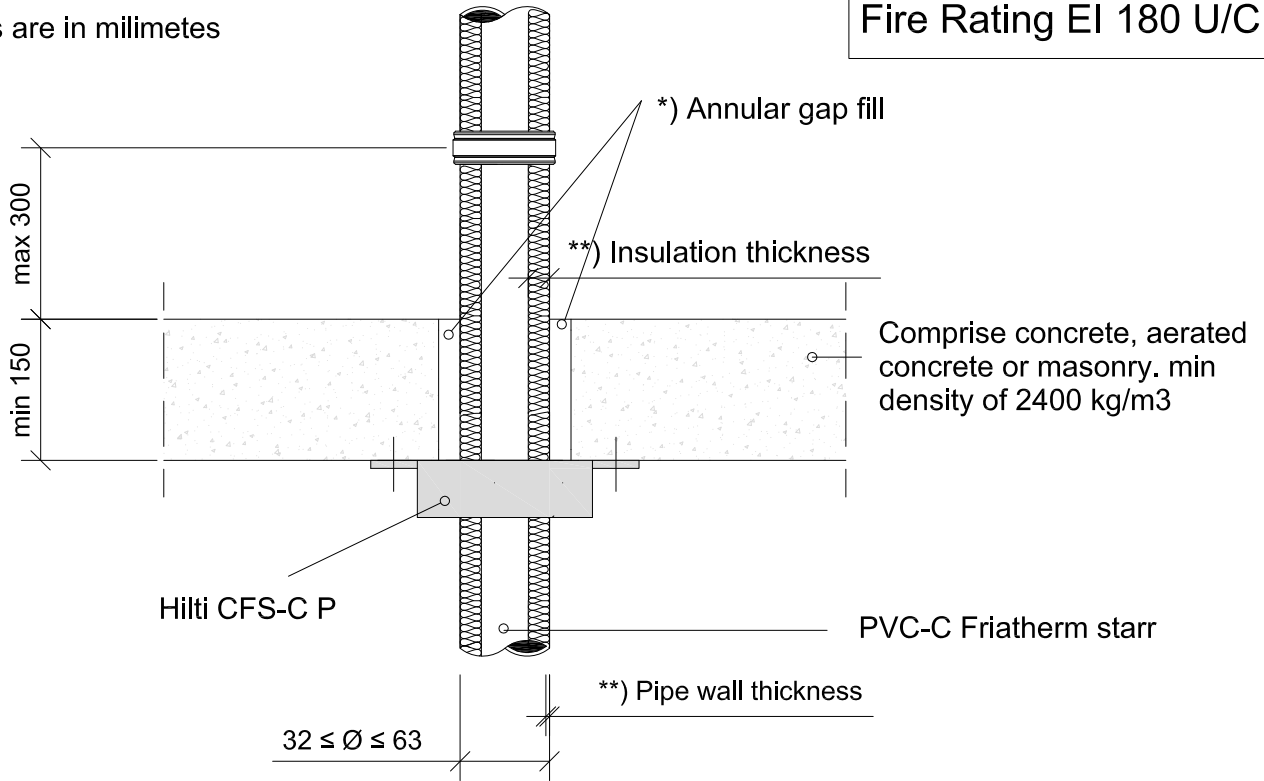

*). Annular gap fill material

Hilti Firestop Acrylic Sealant CFS-S ACR on both sides with depth > 10 mm from the surface of the wall, backfilled with mineral wool min 60 kg/m³.

Gypsum plaster or cementitious mortar over the entire thickness of the floor.

- Approval ETA-14/0404 of 31/01/2013
- Reaction to fire acc EN 13501-1
- Fire resistance test acc 1366-3
- Installation according to Hilti instructions

**). Pipe wall and insulation thickness (Armaflex AF) arrangement Local Insulation (length of insulation > 200 mm) or Continued insulation

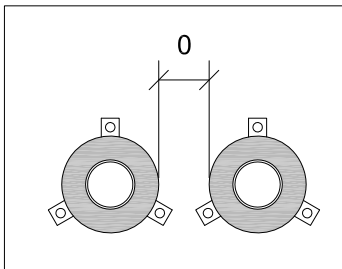

Zero distance between annular gap

| Pipe Ø | Pipe Wall Thickness | Insulation Thickness | Collar Size |
|--------|---------------------|----------------------|-----------------|
| 32 | 3.6 | 9 | CFS-C P 50/1.5" |
| 40 | 4.5 | 9 | CFS-C P 63/2" |
| 50 | 5.6 | 9 | CFS-C P 75/2.5" |
| 63 | 7.1 | 10 | CFS-C P 90/3" |