

Schémas d'applications pour le collier en rouleau CFS-C EL



Applications pour industrie en dalle rigide épaisseur 150 mm

- Tube plastique PE droit IND-RF-PP-0052/53/54/55
- Tube plastique PE incliné IND-RF-PP-0113
- Tube plastique PE (jonction de tube ou tube au mur/
en coin) IND-RF-PP-0115/116/117/118
- Tube plastique PE (sans distance avec autres
systèmes, conlit ou CFS-B) IND-RF-PP-0122/124/125

- Tube plastique ABS et SAN+PVC droit IND-RF-PP-0132/133/134
- Tube plastique ABS et SAN+PVC incliné IND-RF-PP-0137
- Tube plastique ABS et SAN+PVC (jonction de tube
ou tube au mur/en coin) IND-RF-PP-0138/139/140/141/142
- Tube plastique ABS et SAN+PVC (sans distance
avec autres systèmes, conlit ou CFS-B) IND-RF-PP-0147/148/149

*) Tous les schémas sont également disponibles sur demande en format DWG pour faciliter l'insertion sur des plans.



CONTENTS

Straight plastic pipe in a floor

ID

IND-RF-PP-0052

FIRESTOP COLLAR ENDLESS

0052_01

REV

00

No scale

All units are in millimetres

Fire Rating EI 120 U/U

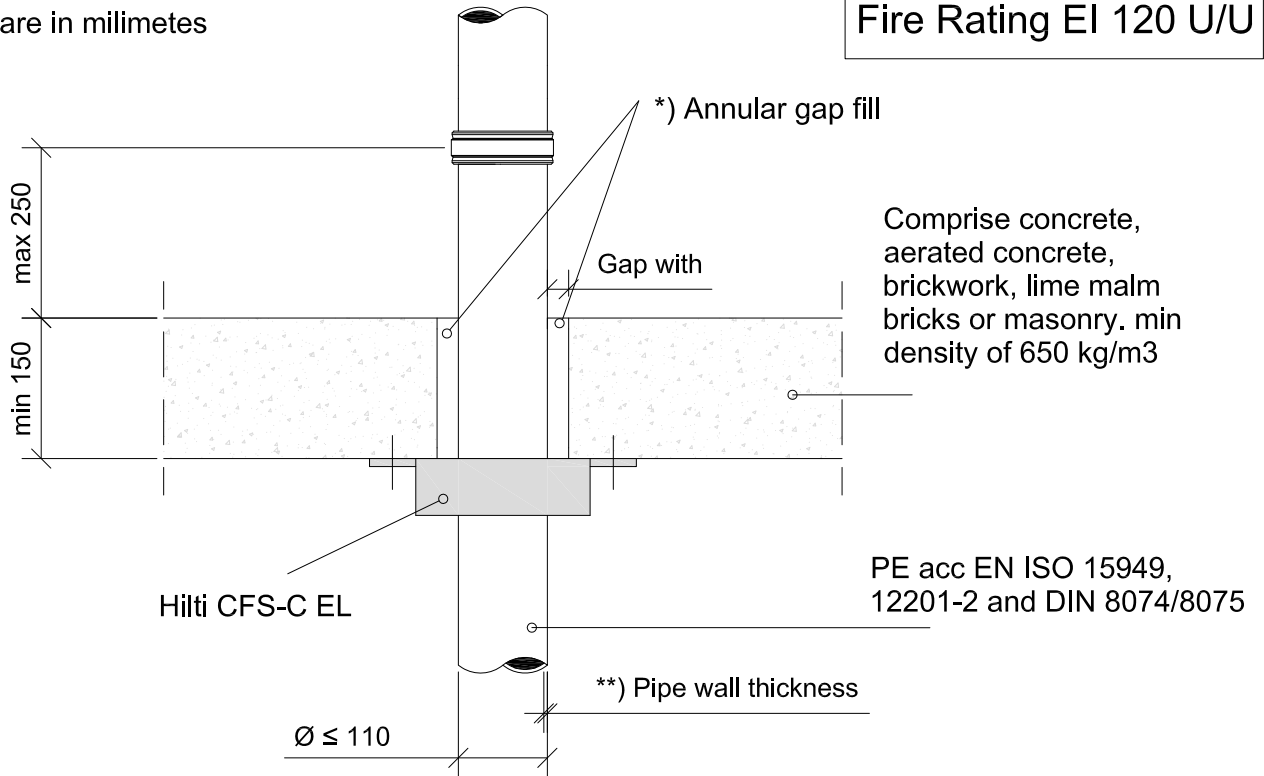

*) Annular gap fill material

Gap with (mm)	Annular Gap Fill
0-15	Hilti Firestop Acrylic Sealant CFS-S ACR only with a depth > 25 mm on both sides of the floor
0-40	Hilti Firestop Acrylic Sealant CFS-S ACR on top side of floor only with depth > 25 mm, backfilled with mineral wool
0-40	Cementitious mortar acc. EN 998-2 group M10 over the entire thickness of the wall.

- Approval ETA-14/0085 of 23/04/2014
- Reaction to fire acc EN 13501-1
- Fire resistance test acc EN 1366-3
- Installation according to Hilti instructions

**) The pipe wall thickness approved can be found in this graphic

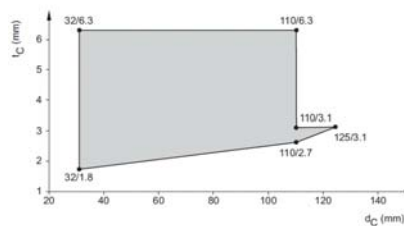



CONTENTS

Straight plastic pipe in a floor

ID

IND-RF-PP-0053

FIRESTOP COLLAR ENDLESS

0053_01

REV

00

No scale

All units are in millimetres

Fire Rating EI 120 U/U

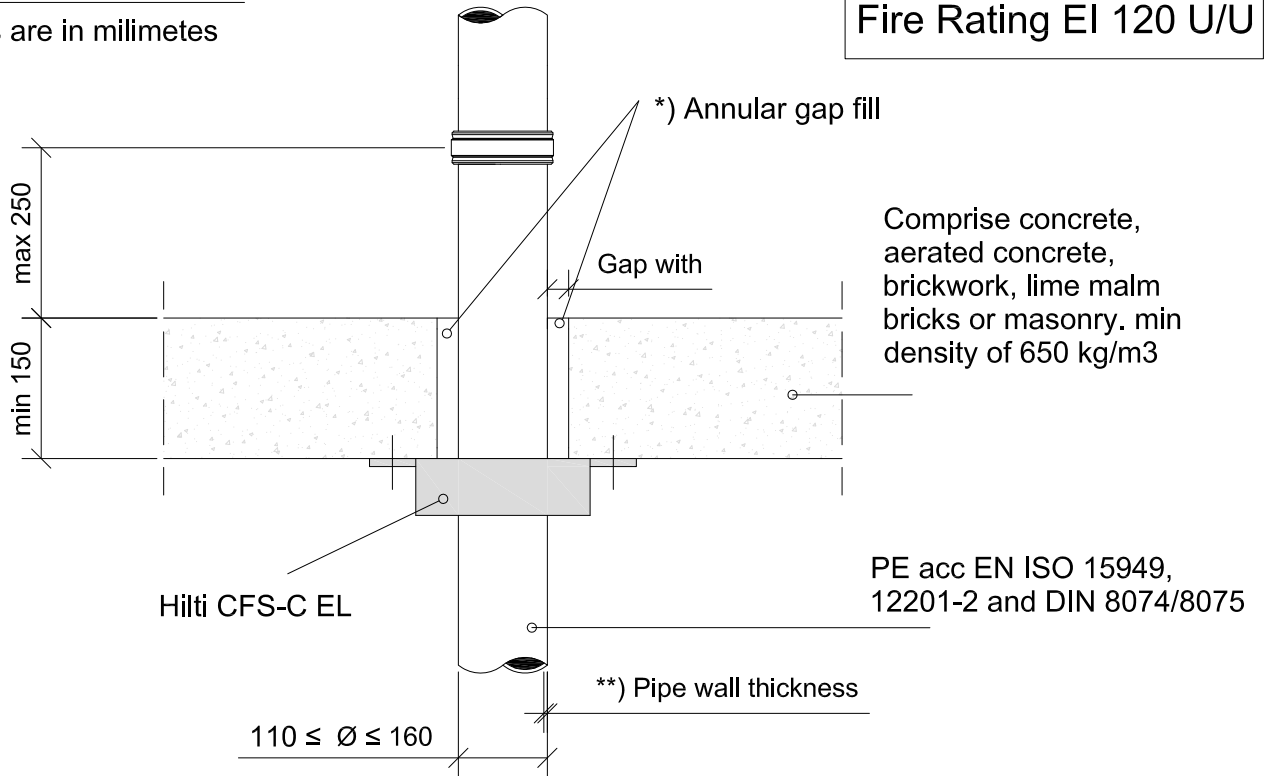

*) Annular gap fill material

Gap with (mm)	Annular Gap Fill
0-15	Hilti Firestop Acrylic Sealant CFS-S ACR only with a depth > 25 mm on both sides of the floor
0-40	Hilti Firestop Acrylic Sealant CFS-S ACR on top side of floor only with depth > 25 mm, backfilled with mineral wool
0-40	Cementitious mortar acc. EN 998-2 group M10 over the entire thickness of the wall.

- Approval ETA-14/0085 of 23/04/2014
- Reaction to fire acc EN 13501-1
- Fire resistance test acc EN 1366-3
- Installation according to Hilti instructions

**) The pipe wall thickness approved can be found in this graphic

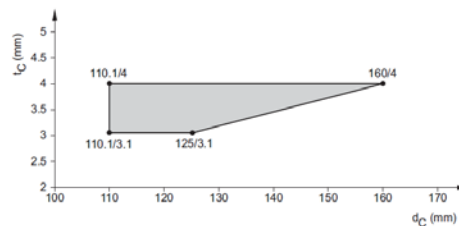



CONTENTS

Straight plastic pipe in a floor

ID

IND-RF-PP-0054

FIRESTOP COLLAR ENDLESS

0054_01

REV

00

No scale

All units are in millimetres

Fire Rating EI 120 U/C

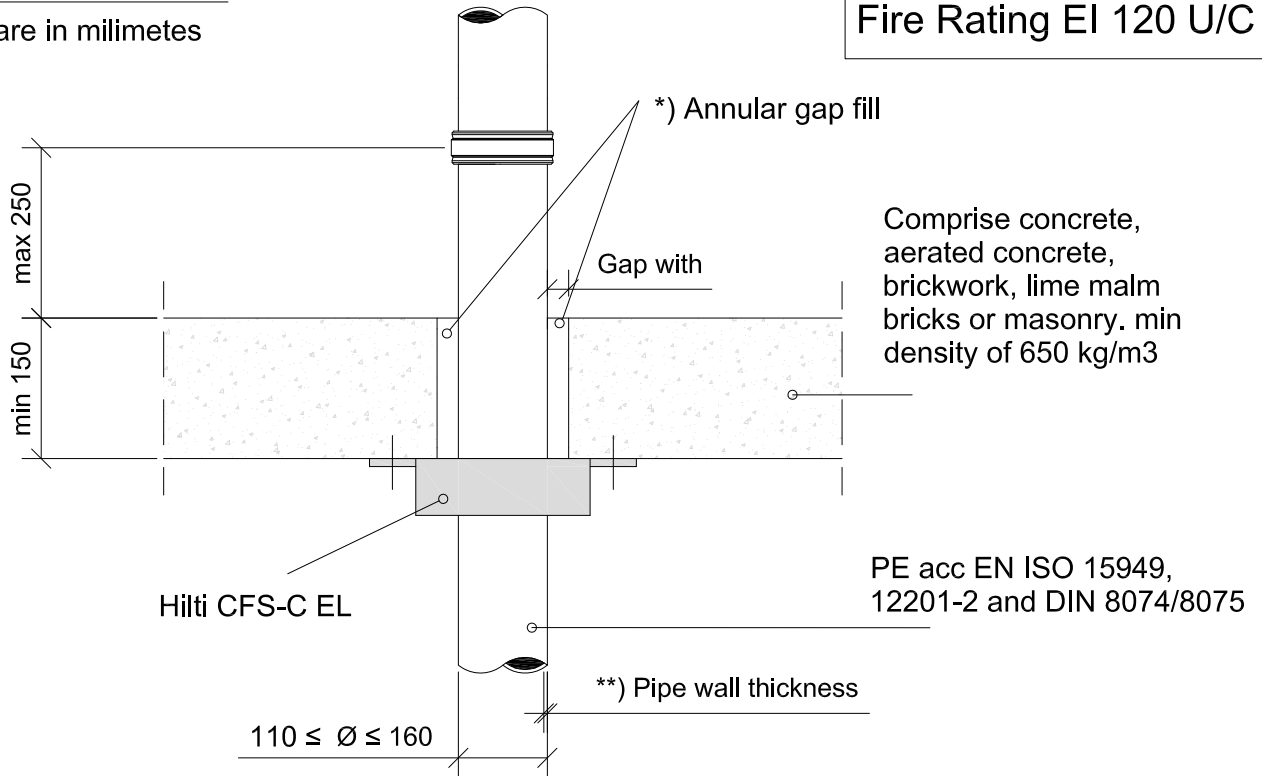

*) Annular gap fill material

Gap with (mm)	Annular Gap Fill
0-15	Hilti Firestop Acrylic Sealant CFS-S ACR only with a depth > 25 mm on both sides of the floor
0-40	Hilti Firestop Acrylic Sealant CFS-S ACR on top side of floor only with depth > 25 mm, backfilled with mineral wool
0-40	Cementitious mortar acc. EN 998-2 group M10 over the entire thickness of the wall.

- Approval ETA-14/0085 of 23/04/2014
- Reaction to fire acc EN 13501-1
- Fire resistance test acc EN 1366-3
- Installation according to Hilti instructions

**) The pipe wall thickness approved can be found in this graphic

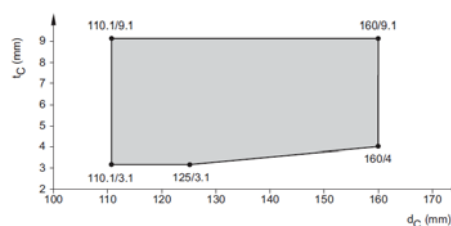



CONTENTS

Straight plastic pipe in a floor

ID

IND-RF-PP-0055

FIRESTOP COLLAR ENDLESS

0055_01

REV

00

No scale

All units are in milimetres

Fire Rating EI 90 U/U

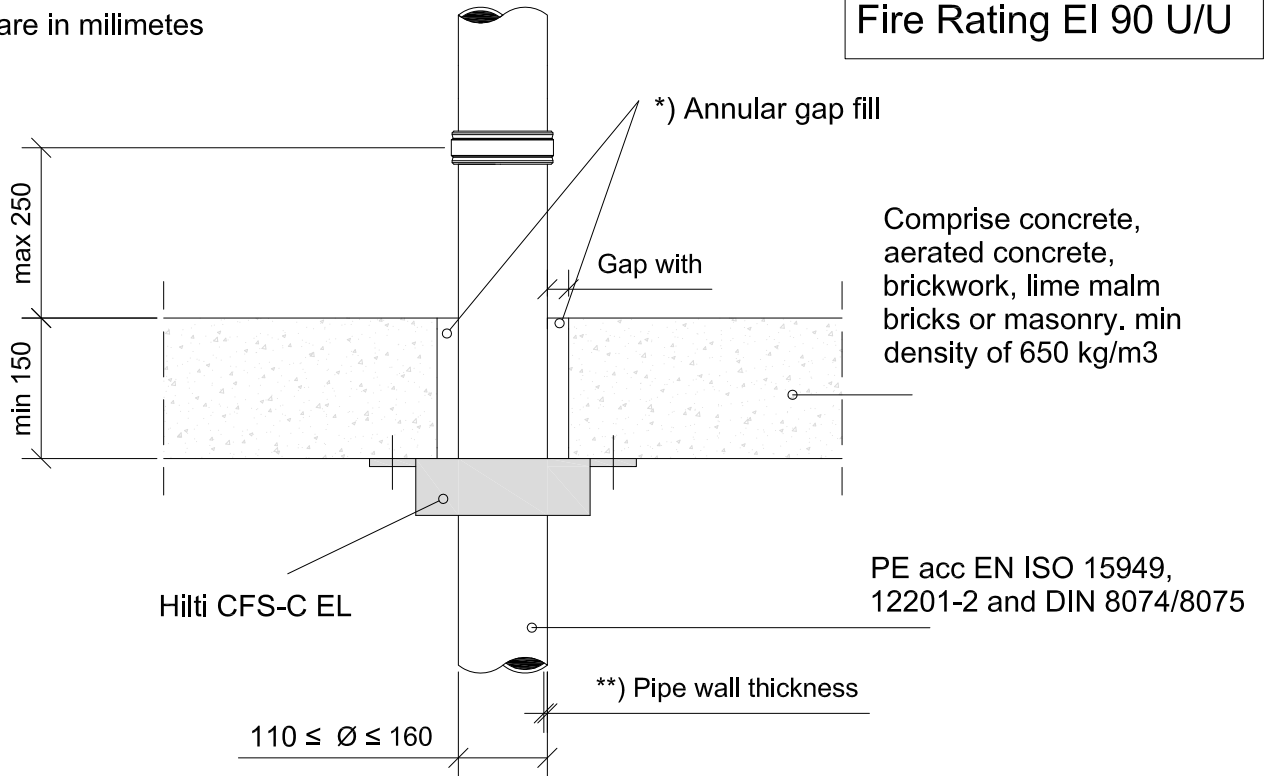

*) Annular gap fill material

Gap with (mm)	Annular Gap Fill
0-15	Hilti Firestop Acrylic Sealant CFS-S ACR only with a depth > 25 mm on both sides of the floor
0-40	Hilti Firestop Acrylic Sealant CFS-S ACR on top side of floor only with depth > 25 mm, backfilled with mineral wool
0-40	Cementitious mortar acc. EN 998-2 group M10 over the entire thickness of the wall.

- Approval ETA-14/0085 of 23/04/2014
- Reaction to fire acc EN 13501-1
- Fire resistance test acc EN 1366-3
- Installation according to Hilti instructions

**). The pipe wall thickness approved can be found in this graphic

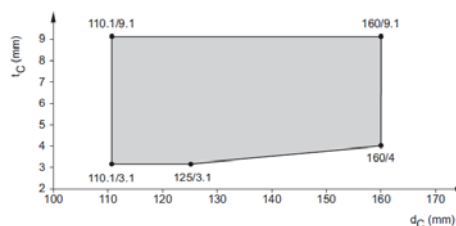



CONTENTS

Inclined plastic pipe in a floor

ID

IND-RF-PP-0113

FIRESTOP COLLAR ENDLESS

0113_01

REV

00

No scale

All units are in millimetres

PE acc EN ISO 15949,
12201-2 and DIN 8074/8075

Fire Rating EI 120 U/U

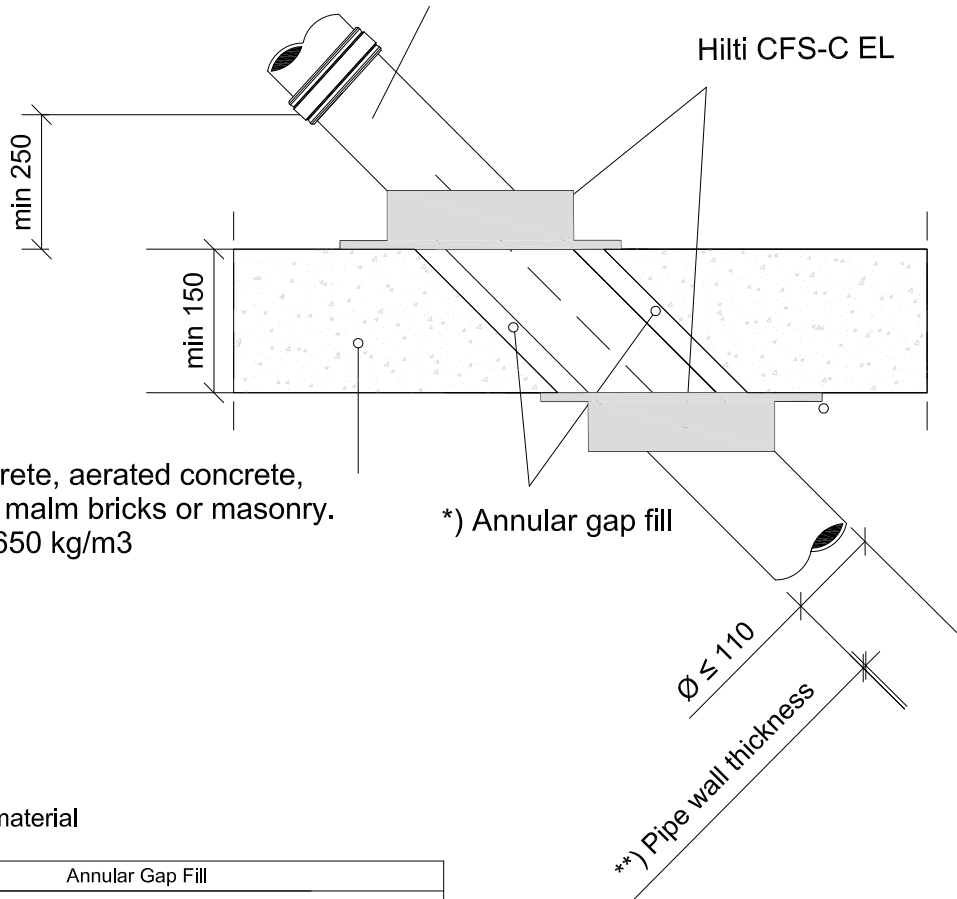

Comprise concrete, aerated concrete, brickwork, lime malm bricks or masonry. min density of 650 kg/m³

*) Annular gap fill

*) Annular gap fill material

Gap with (mm)	Annular Gap Fill
0-15	Hilti Firestop Acrylic Sealant CFS-S ACR only with a depth > 25 mm on both sides of the floor
0-40	Hilti Firestop Acrylic Sealant CFS-S ACR on top side of floor only with depth > 25 mm, backfilled with mineral wool
0-40	Cementious mortar acc. EN 998-2 group M10 over the entire thickness of the wall.

- Approval ETA-14/0085 of 23/04/2014
- Reaction to fire acc EN 13501-1
- Fire resistance test acc EN 1366-3
- Installation according to Hilti instructions

**) The pipe wall thickness approved can be found in this graphic

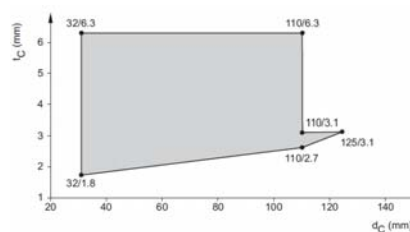



CONTENTS

Plastic pipe in a rigid floor

ID

IND-RF-PP-0115

FIRESTOP COLLAR ENDLESS

0115_01

REV
00

No scale

All units are in millimetres

Fire Rating EI 120 U/U

Comprise concrete, aerated concrete, brickwork, lime malm bricks or masonry. min density of 650 kg/m³

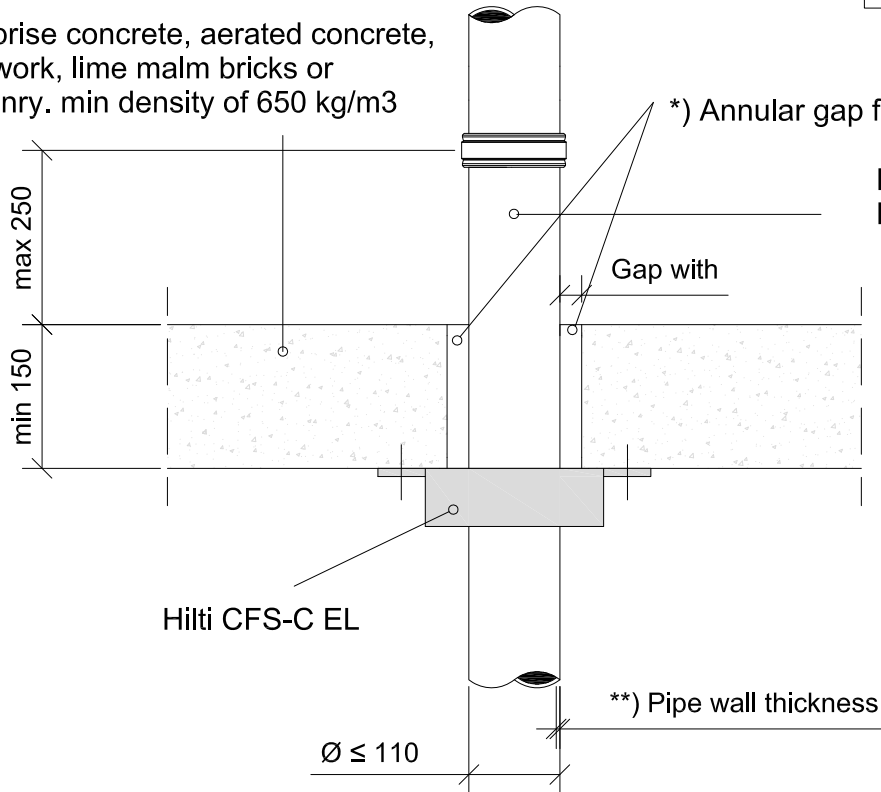

PP acc EN 1451-1 and
DIN 8077/78

*) Annular gap fill material

Gap with (mm)	Annular Gap Fill
0-15	Hilti Firestop Acrylic Sealant CFS-S ACR only with a depth > 25 mm on both sides of the floor
0-40	Hilti Firestop Acrylic Sealant CFS-S ACR on top side of floor only with depth > 25 mm, backfilled with mineral wool
0-40	Cementious mortar acc. EN 998-2 group M10 over the entire thickness of the wall.

- Approval ETA-14/0085 of 23/04/2014
- Reaction to fire acc EN 13501-1
- Fire resistance test acc EN 1366-3
- Installation according to Hilti instructions

**) The pipe wall thickness approved can be found in this graphic

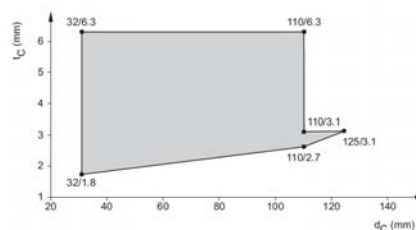
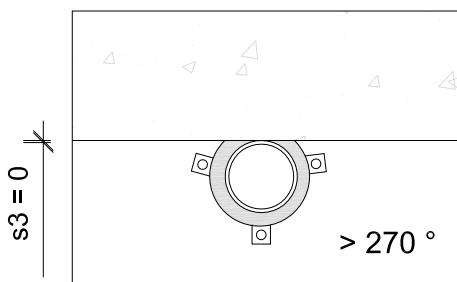



CONTENTS

Plastic pipe junction in floors
(Manifold)

ID

IND-RF-PP-0116

FIRESTOP COLLAR ENDLESS

0116_01

REV

00

No scale

All units are in millimetres

Fire Rating EI 120 U/U

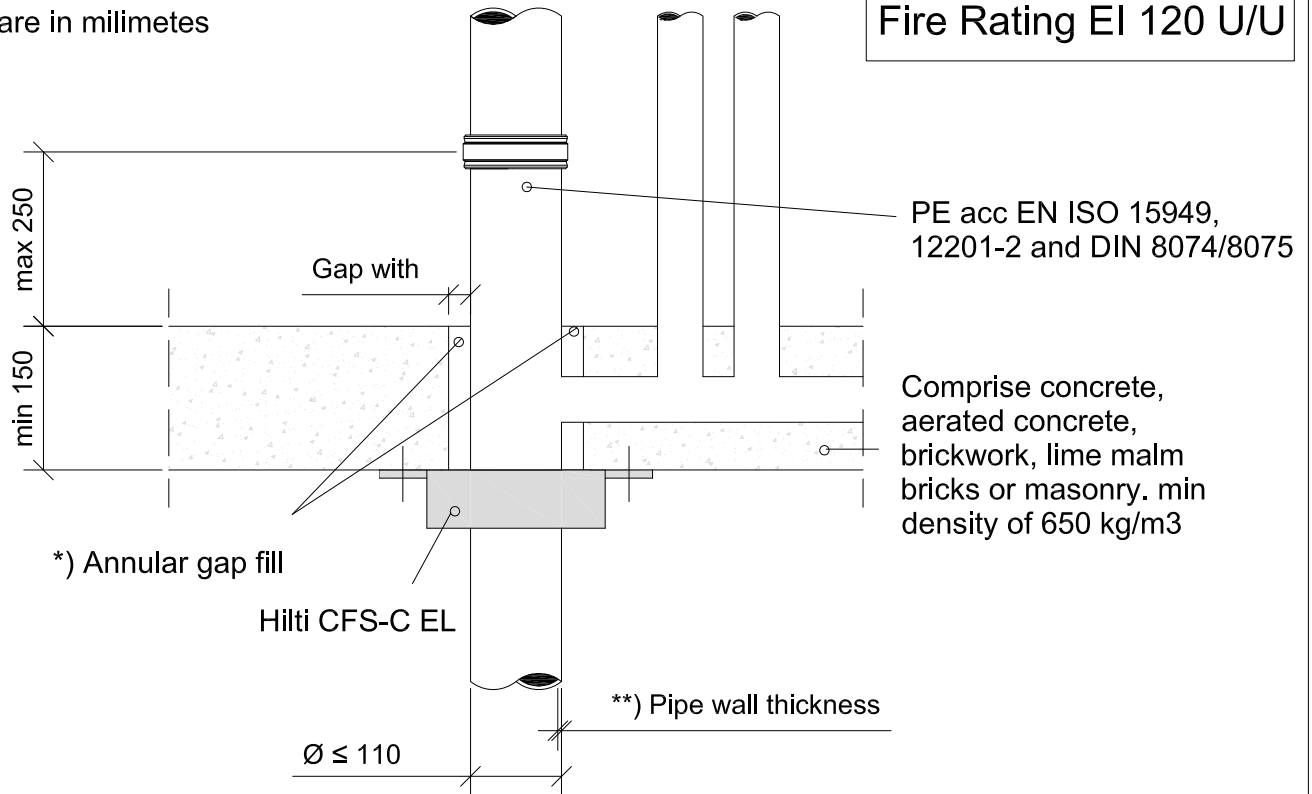

*) Annular gap fill

Hilti CFS-C EL

***) Pipe wall thickness

$\varnothing \le 110$

*) Annular gap fill material

Gap with (mm)	Annular Gap Fill
0-15	Hilti Firestop Acrylic Sealant CFS-S ACR only with a depth > 25 mm on both sides of the floor
0-40	Hilti Firestop Acrylic Sealant CFS-S ACR on top side of floor only with depth > 25 mm, backfilled with mineral wool
0-40	Cementitious mortar acc. EN 998-2 group M10 over the entire thickness of the wall.

- Approval ETA-14/0085 of 23/04/2014
- Reaction to fire acc EN 13501-1
- Fire resistance test acc EN 1366-3
- Installation according to Hilti instructions

DESCRIPTION

Inside the floor there are one or more pipe junctions/manifolds into the central waste water pipe, where horizontal running minor pipes flow to. Those minor pipes have a U/C end configuration and can be installed in line on an unlimited amount. The CFS-C EL shall be installed only on the bottom part of the central waste water pipe.

**) The pipe wall thickness approved can be found in this graphic

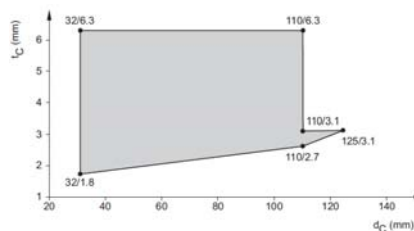



CONTENTS

Plastic pipe junction in floors
(Manifold)

ID

IND-RF-PP-0117

FIRESTOP COLLAR ENDLESS

0117_01

REV

00

No scale

All units are in millimetres

Fire Rating EI 90 U/U

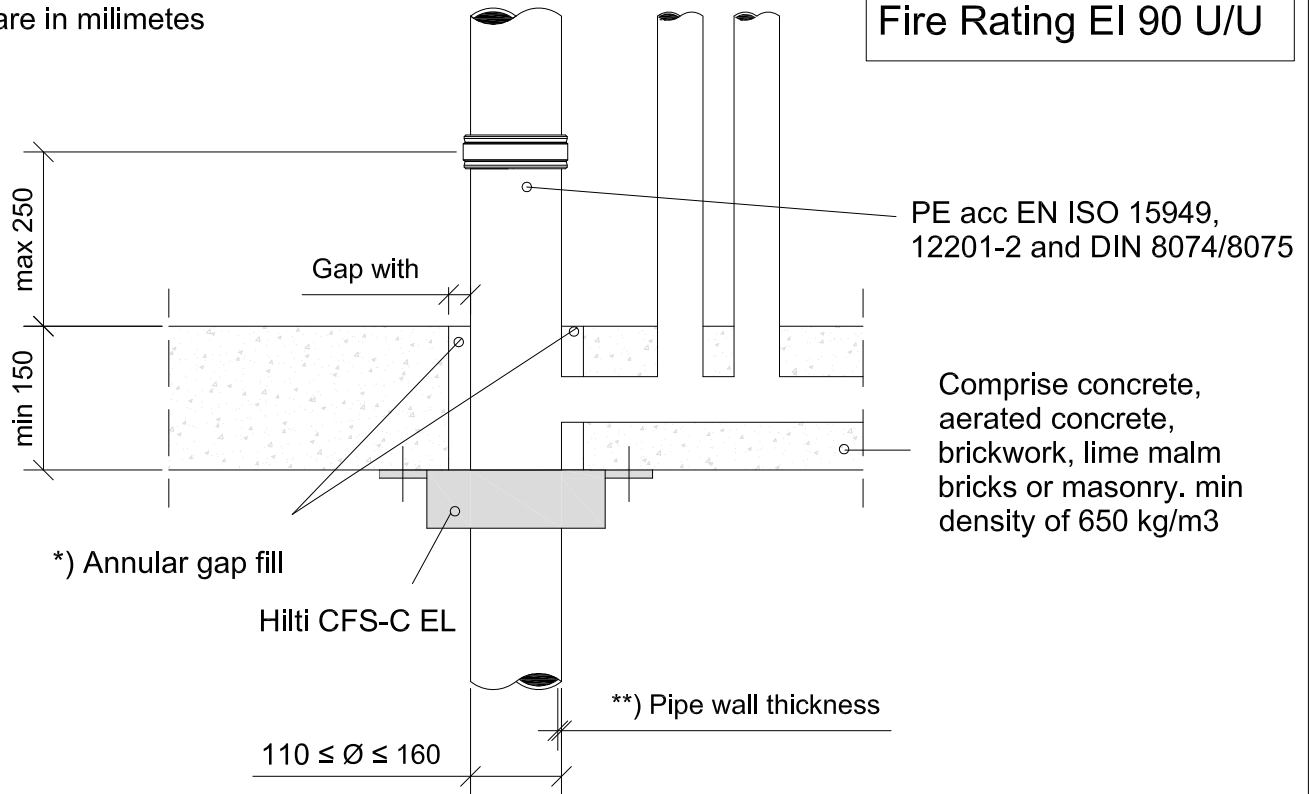

*) Annular gap fill material

Gap with (mm)	Annular Gap Fill
0-15	Hilti Firestop Acrylic Sealant CFS-S ACR only with a depth > 25 mm on both sides of the floor
0-40	Hilti Firestop Acrylic Sealant CFS-S ACR on top side of floor only with depth > 25 mm, backfilled with mineral wool
0-40	Cementious mortar acc. EN 998-2 group M10 over the entire thickness of the wall.

- Approval ETA-14/0085 of 23/04/2014
- Reaction to fire acc EN 13501-1
- Fire resistance test acc EN 1366-3
- Installation according to Hilti instructions

DESCRIPTION

Inside the floor there are one or more pipe junctions/manifolds into the central waste water pipe, where horizontal running minor pipes flow to. Those minor pipes have a U/C end configuration and can be installed in line on an unlimited amount. The CFS-C EL shall be installed only on the bottom part of the central waste water pipe.

**) The pipe wall thickness approved can be found in this graphic

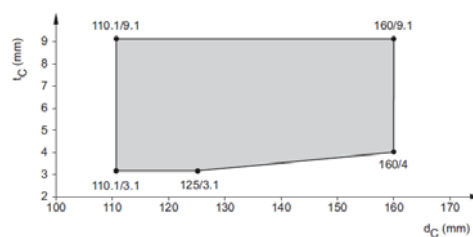



CONTENTS

Plastic pipe junction in floors
(Manifold)

ID

IND-RF-PP-0118

FIRESTOP COLLAR ENDLESS

0118_01

REV

00

No scale

All units are in millimetres

Fire Rating EI 120 U/U

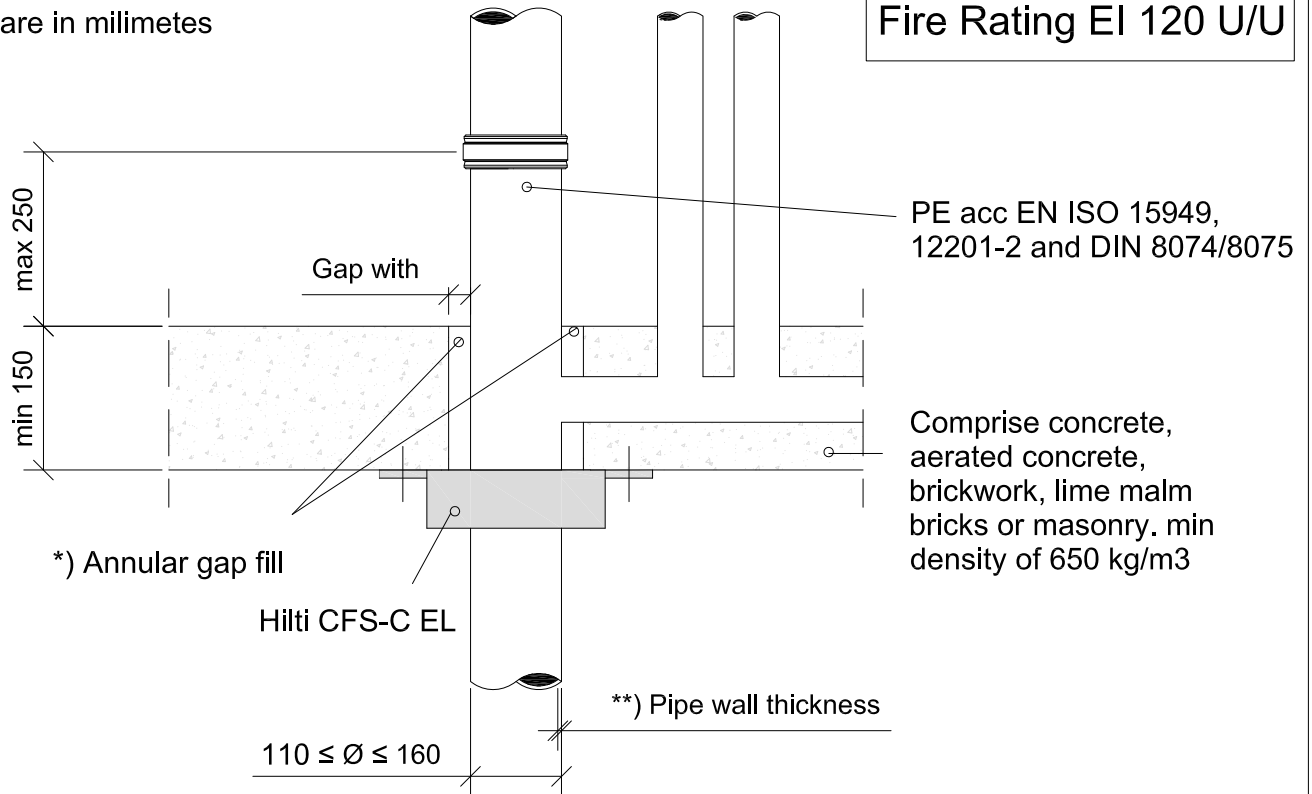

*) Annular gap fill

Hilti CFS-C EL

**) Pipe wall thickness

$110 \leq \varnothing \leq 160$

*) Annular gap fill material

Gap with (mm)	Annular Gap Fill
0-15	Hilti Firestop Acrylic Sealant CFS-S ACR only with a depth > 25 mm on both sides of the floor
0-40	Hilti Firestop Acrylic Sealant CFS-S ACR on top side of floor only with depth > 25 mm, backfilled with mineral wool
0-40	Cementitious mortar acc. EN 998-2 group M10 over the entire thickness of the wall.

- Approval ETA-14/0085 of 23/04/2014
- Reaction to fire acc EN 13501-1
- Fire resistance test acc EN 1366-3
- Installation according to Hilti instructions

DESCRIPTION

Inside the floor there are one or more pipe junctions/manifolds into the central waste water pipe, where horizontal running minor pipes flow to. Those minor pipes have a U/C end configuration and can be installed in line on an unlimited amount. The CFS-C EL shall be installed only on the bottom part of the central waste water pipe.

**) The pipe wall thickness approved can be found in this graphic

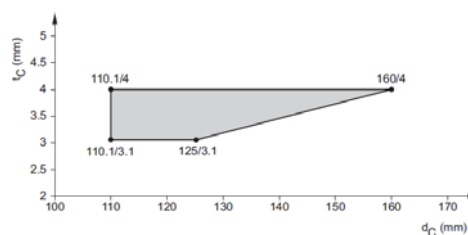



CONTENTS

Zero distance to other system,
Conlit or CFS-B

ID

IND-RF-PP-0122

FIRESTOP COLLAR ENDLESS

0122_01

REV

00

No scale

All units are in millimetres

Fire Rating EI 120 U/U

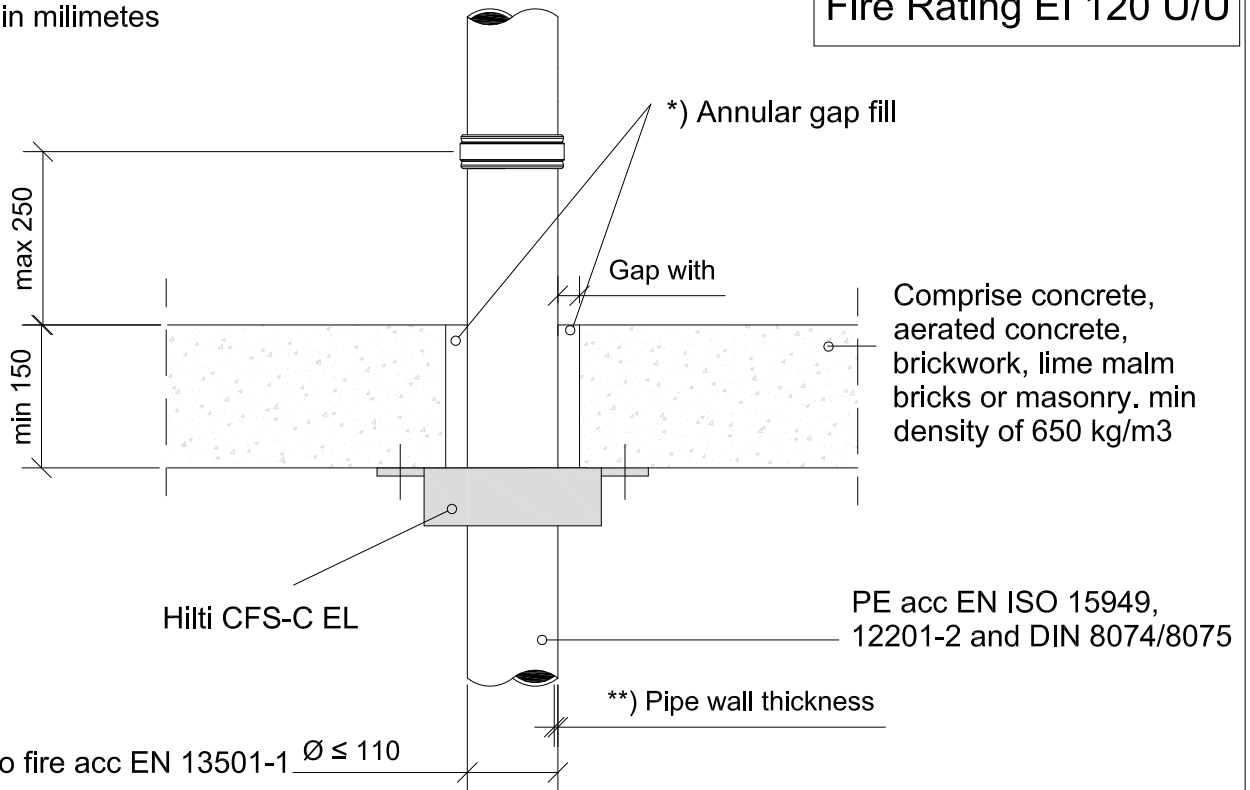

- Reaction to fire acc EN 13501-1 $\varnothing \leq 110$
- Fire resistance test acc EN 1366-3
- Installation according to Hilti instructions
- Approval ETA-14/0085 of 23/04/2014

Approved pipes and insulation to be used with Conlit 150, Rockwool 800 and CFS-B

Pipes types	Copper, unalloyed steel, alloyed steel, cast iron, stainless steel
Pipe outside diameter	dm < 42 mm
Pipe thickness	1.2 mm < tm < 14.2 mm
Elastomeric foamed thermal insulation	CS with minimum length (ld>250mm) on both sides of the wall.
Elastomeric foamed thermal insulation thickness	9 mm < De < 35 mm
Incombustible thermal insulation, based on mineral wool (combustibility class A1 or A2 in acc EN 13501	- Conlit 150 inside the wall/floor only with Insulation thickness (td>19 mm) - Rockwool 800, covering the metal pipe outside the wall/floor with Insulation thickness td> 20 mm

*) Annular gap fill material

Gap with (mm)	Annular Gap Fill
0-15	Hilti Firestop Acrylic Sealant CFS-S ACR only with a depth > 25 mm on both sides of the floor
0-40	Hilti Firestop Acrylic Sealant CFS-S ACR on top side of floor only with depth > 25 mm, backfilled with mineral wool
0-40	Cementitious mortar acc. EN 998-2 group M10 over the entire thickness of the wall.

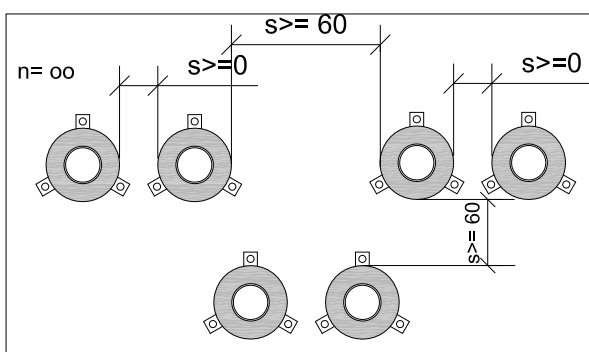

**) The pipe wall thickness approved can be found in this graphic

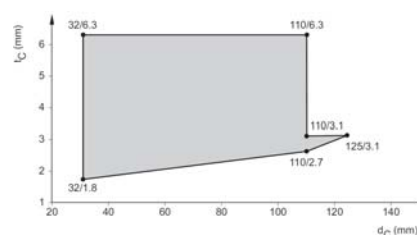



CONTENTS

Zero distance to other system

ID

IND-RF-PP-0124

FIRESTOP COLLAR ENDLESS

0124_01

REV

00

No scale

All units are in millimetres

Fire Rating EI 120 U/U

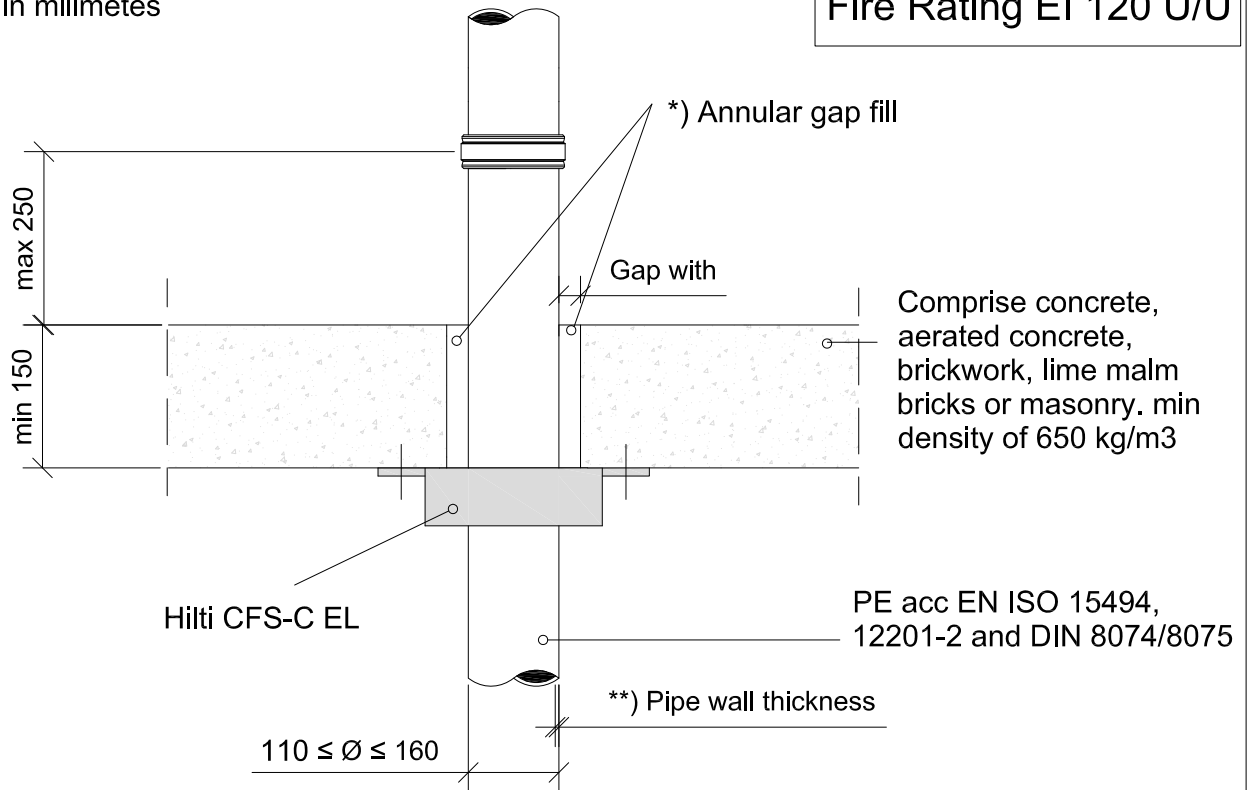

*) Annular gap fill material

Gap with (mm)	Annular Gap Fill
0-15	Hilti Firestop Acrylic Sealant CFS-S ACR only with a depth > 25 mm on both sides of the floor
0-40	Hilti Firestop Acrylic Sealant CFS-S ACR on top side of floor only with depth > 25 mm, backfilled with mineral wool
0-40	Cementitious mortar acc. EN 998-2 group M10 over the entire thickness of the wall.

- Approval ETA-14/0085 of 23/04/2014
- Reaction to fire acc EN 13501-1
- Fire resistance test acc EN 1366-3
- Installation according to Hilti instructions

***) The pipe wall thickness approved can be found in this graphic

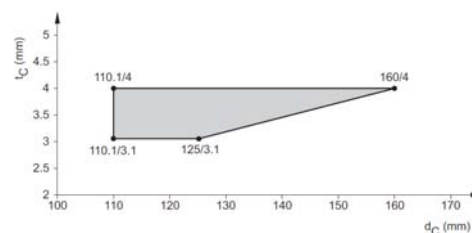
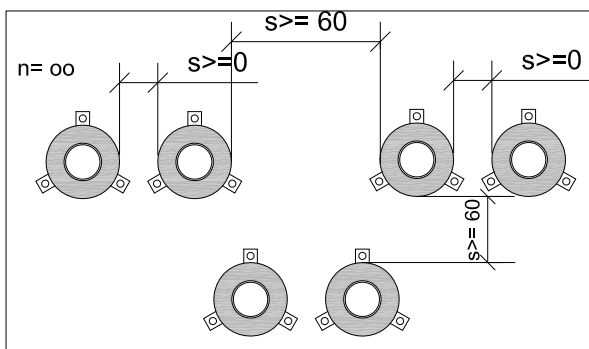



CONTENTS

Zero distance to CFS-B

ID

IND-RF-PP-0125

FIRESTOP COLLAR ENDLESS

0125_01

REV

00

No scale

All units are in millimetres

Fire Rating EI 90 U/U

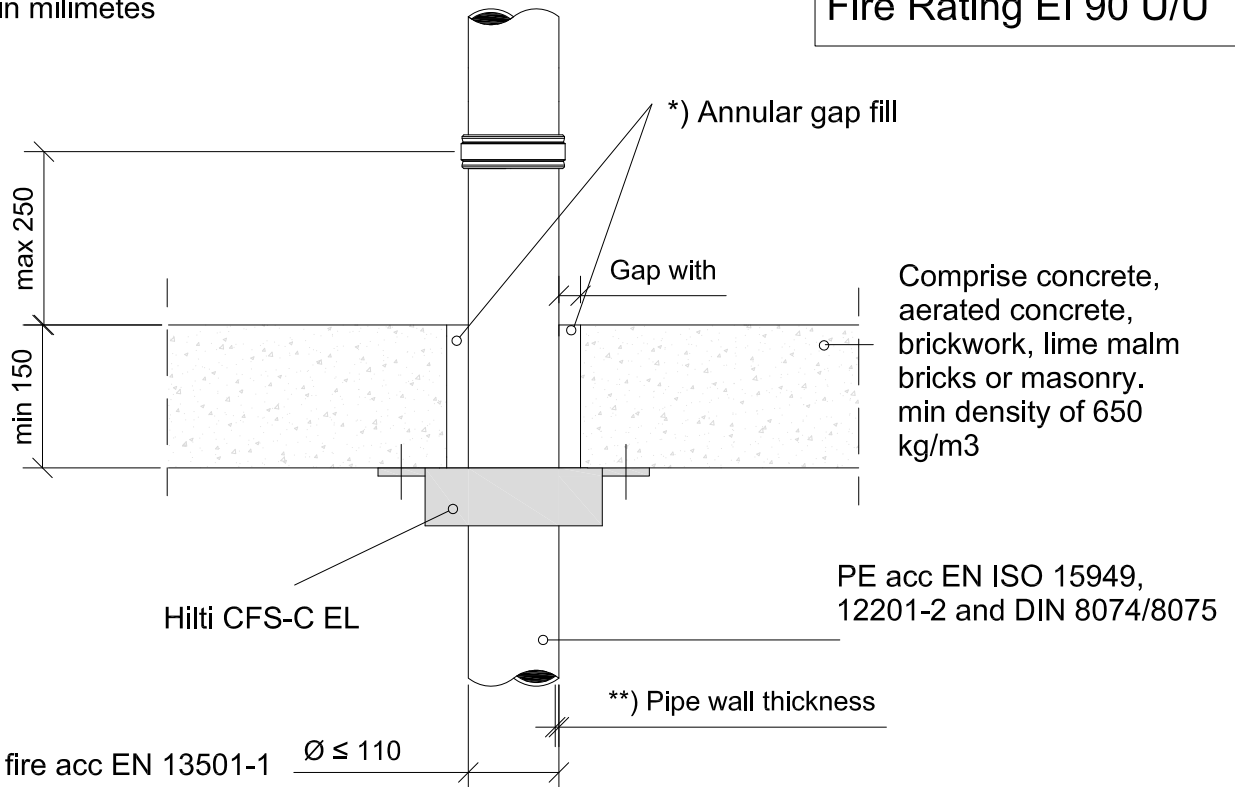

Comprise concrete, aerated concrete, brickwork, lime malm bricks or masonry. min density of 650 kg/m³

PE acc EN ISO 15949, 12201-2 and DIN 8074/8075

- Reaction to fire acc EN 13501-1 $\varnothing \leq 110$
- Fire resistance test acc EN 1366-3
- Installation according to Hilti instructions
- Approval ETA-14/0085 of 23/04/2014

Approved pipes and insulation to be used with CFS-B

*) Annular gap fill material

Gap with (mm)	Annular Gap Fill
0-15	Hilti Firestop Acrylic Sealant CFS-S ACR only with a depth > 25 mm on both sides of the floor
0-40	Hilti Firestop Acrylic Sealant CFS-S ACR on top side of floor only with depth > 25 mm, backfilled with mineral wool
0-40	Cementitious mortar acc. EN 998-2 group M10 over the entire thickness of the wall.

Pipes types	Copper, unalloyed steel, alloyed steel, cast iron, stainless steel
Pipe outside diameter	dm < 42 mm
Pipe thickness	1.2 mm < tm < 14.2 mm
Elastomeric foamed thermal insulation	CS with minimum length (ld>250mm) on both sides of the floor.
Elastomeric foamed thermal insulation thickness	9 mm < De < 35 mm

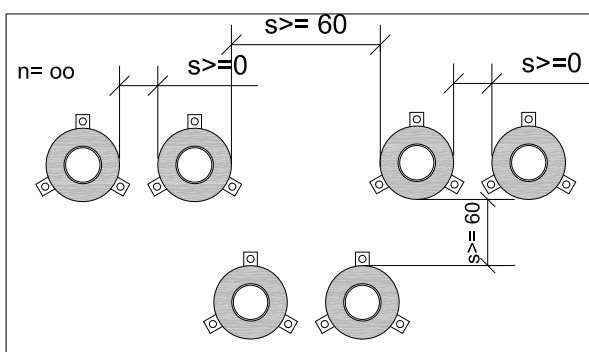

**) The pipe wall thickness approved can be found in this graphic

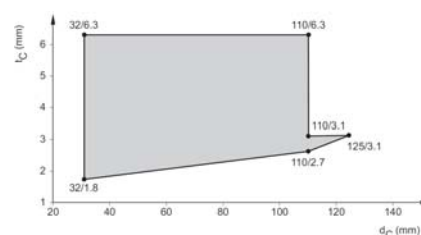



CONTENTS

Straight plastic pipe in a floor

ID

IND-RF-PP-0132

FIRESTOP COLLAR ENDLESS

0132_01

REV

00

No scale

All units are in millimetres

Fire Rating EI 120 U/U

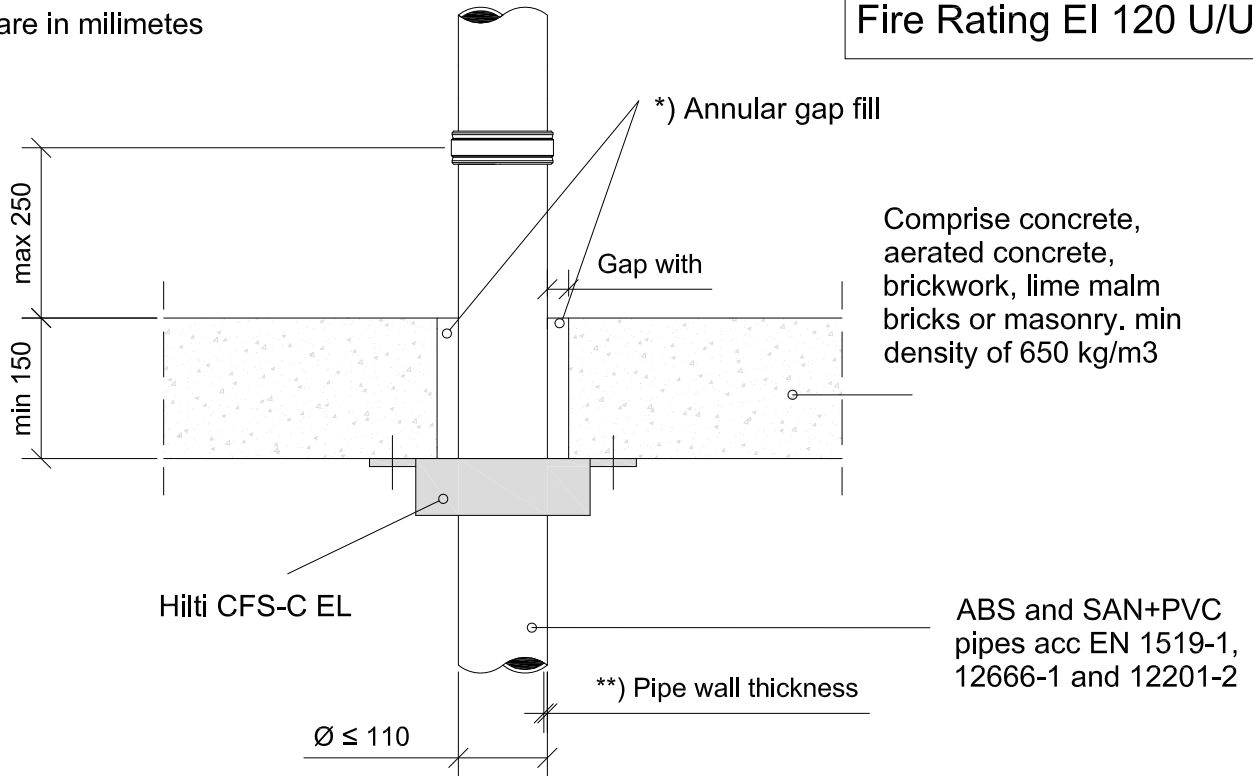

*) Annular gap fill material

Gap with (mm)	Annular Gap Fill
0-15	Hilti Firestop Acrylic Sealant CFS-S ACR only with a depth > 25 mm on both sides of the floor
0-40	Hilti Firestop Acrylic Sealant CFS-S ACR on top side of floor only with depth > 25 mm, backfilled with mineral wool
0-40	Cementitious mortar acc. EN 998-2 group M10 over the entire thickness of the wall.

- Approval ETA-14/0085 of 23/04/2014
- Reaction to fire acc EN 13501-1
- Fire resistance test acc EN 1366-3
- Installation according to Hilti instructions

***) The pipe wall thickness approved can be found in this graphic

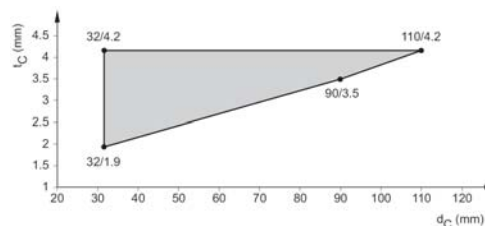



CONTENTS

Straight plastic pipe in a floor

ID

IND-RF-PP-0133

FIRESTOP COLLAR ENDLESS

0133_01

REV

00

No scale

All units are in millimetres

Fire Rating EI 120 U/U

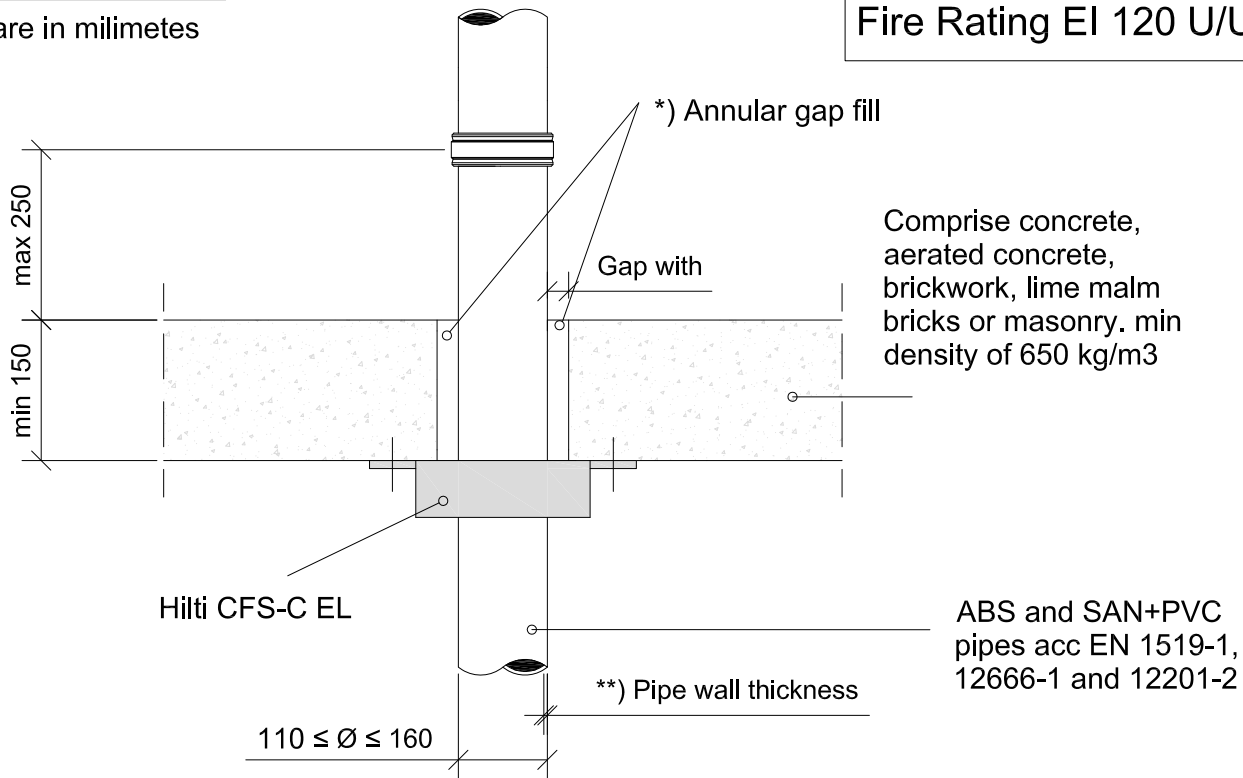

*) Annular gap fill material

Gap with (mm)	Annular Gap Fill
0-15	Hilti Firestop Acrylic Sealant CFS-S ACR only with a depth > 25 mm on both sides of the floor
0-40	Hilti Firestop Acrylic Sealant CFS-S ACR on top side of floor only with depth > 25 mm, backfilled with mineral wool
0-40	Cementitious mortar acc. EN 998-2 group M10 over the entire thickness of the wall.

- Approval ETA-14/0085 of 23/04/2014
- Reaction to fire acc EN 13501-1
- Fire resistance test acc EN 1366-3
- Installation according to Hilti instructions

**) The pipe wall thickness approved can be found in this graphic

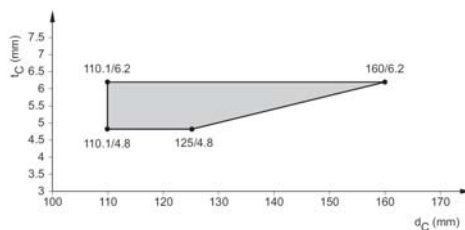



CONTENTS

Straight plastic pipe in a floor

ID

IND-RF-PP-0134

FIRESTOP COLLAR ENDLESS

0134_01

REV

00

No scale

All units are in millimetres

Fire Rating EI 60 U/U

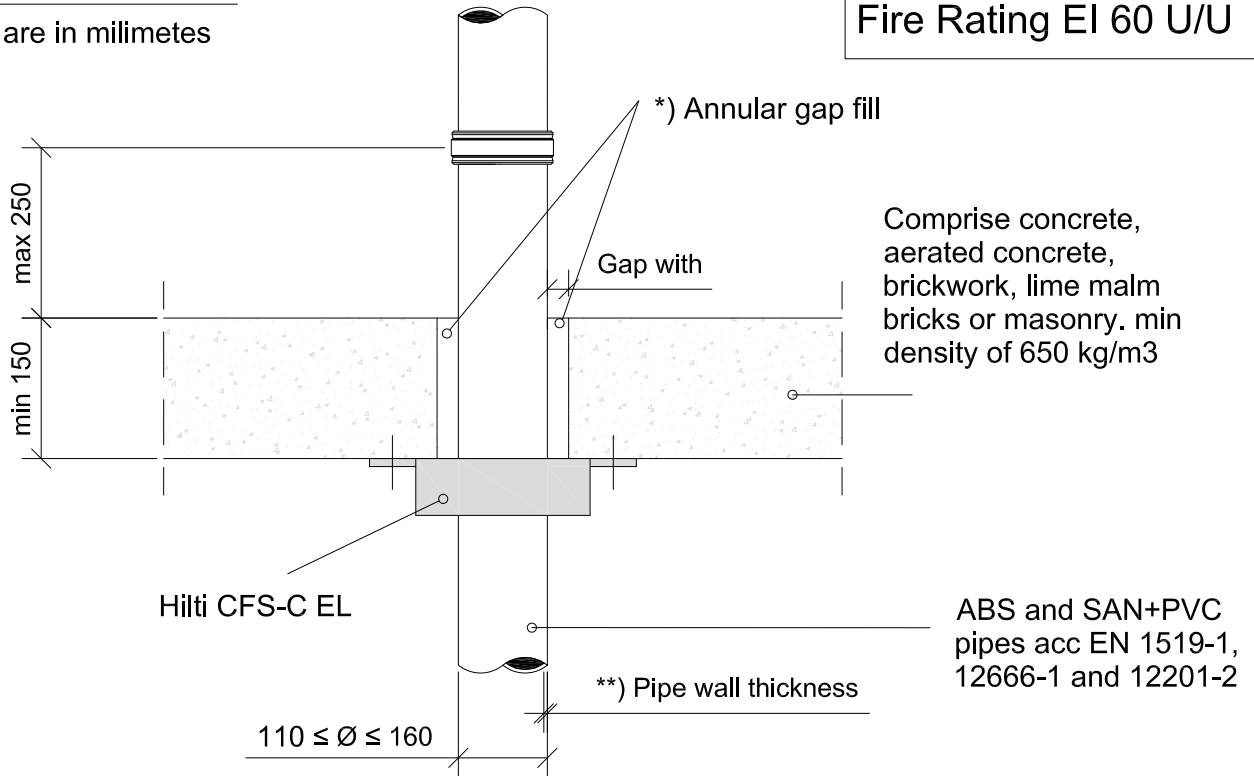

Comprise concrete, aerated concrete, brickwork, lime malm bricks or masonry. min density of 650 kg/m³

ABS and SAN+PVC pipes acc EN 1519-1, 12666-1 and 12201-2

***) Annular gap fill material**

Gap with (mm)	Annular Gap Fill
0-15	Hilti Firestop Acrylic Sealant CFS-S ACR only with a depth > 25 mm on both sides of the floor
0-40	Hilti Firestop Acrylic Sealant CFS-S ACR on top side of floor only with depth > 25 mm, backfilled with mineral wool
0-40	Cementitious mortar acc. EN 998-2 group M10 over the entire thickness of the wall.

- Approval ETA-14/0085 of 23/04/2014
- Reaction to fire acc EN 13501-1
- Fire resistance test acc EN 1366-3
- Installation according to Hilti instructions

****) The pipe wall thickness approved can be found in this graphic**

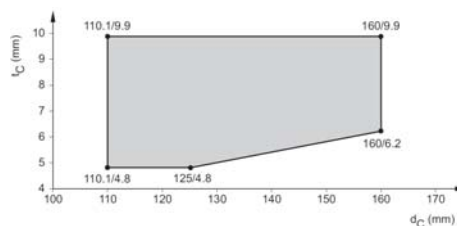



CONTENTS

Inclined plastic pipe in a rigid floor

ID

IND-RF-PP-0137

FIRESTOP COLLAR ENDLESS

0137_01

REV

00

No scale

All units are in millimetres

ABS and SAN+PVC pipes acc EN 1519-1, 12666-1 and 12201-2

Fire Rating EI 120 U/U

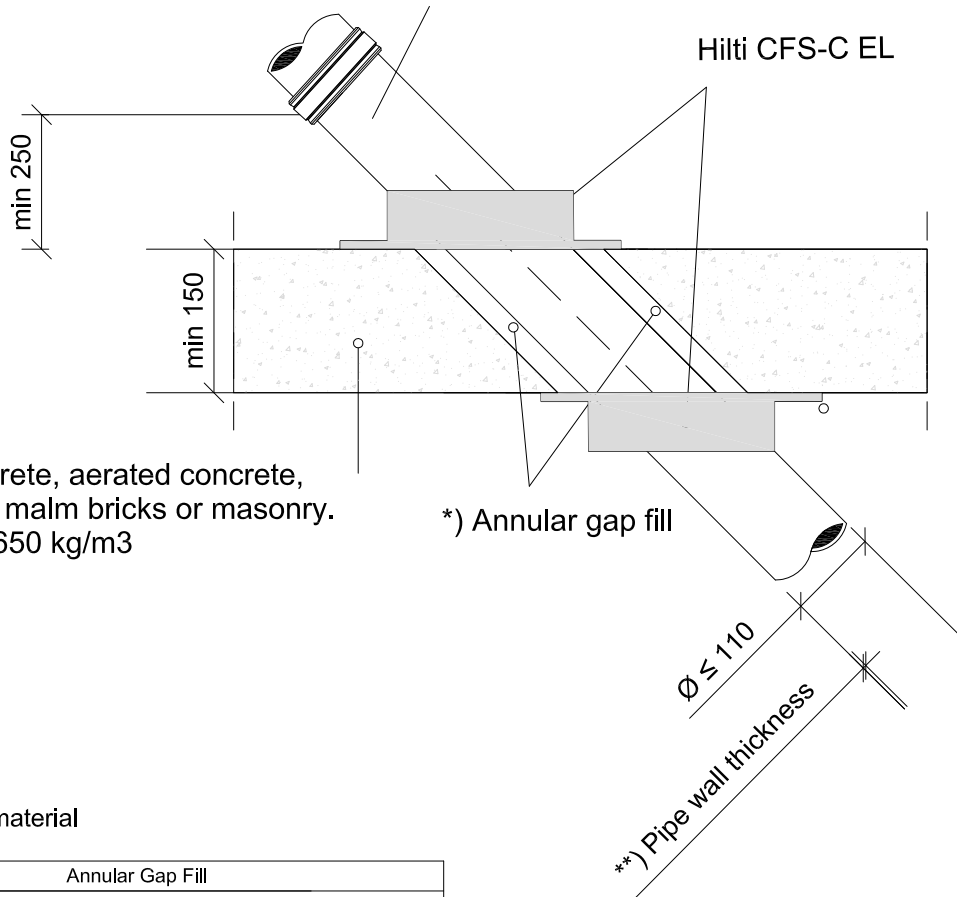

Comprise concrete, aerated concrete, brickwork, lime malm bricks or masonry. min density of 650 kg/m³

*) Annular gap fill material

Gap with (mm)	Annular Gap Fill
0-15	Hilti Firestop Acrylic Sealant CFS-S ACR only with a depth > 25 mm on both sides of the floor
0-40	Hilti Firestop Acrylic Sealant CFS-S ACR on top side of floor only with depth > 25 mm, backfilled with mineral wool
0-40	Cementious mortar acc. EN 998-2 group M10 over the entire thickness of the wall.

- Approval ETA-14/0085 of 23/04/2014
- Reaction to fire acc EN 13501-1
- Fire resistance test acc EN 1366-3
- Installation according to Hilti instructions

**) The pipe wall thickness approved can be found in this graphic

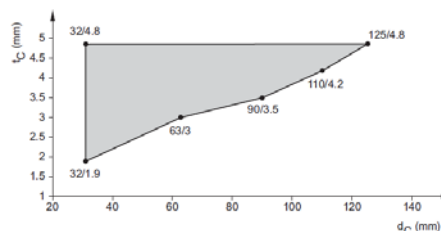

HUOM! Mikäli dokumentin sisältöä muokataan, tulee hyväksynnän kattavuus tarkistaa.

LEGAL NOTICE: This template contains Hilti Intellectual Property which is legally protected, including Community registration of Hilti trademarks. For use only by Hilti customers and in conjunction with Hilti products. No third party use/products is authorised and breaches Hilti's intellectual property rights. Hilti accepts no responsibility for unauthorized use and reserves all rights to take legal action to enforce its rights in law.



CONTENTS

Plastic pipe on the wall

ID

IND-RF-PP-0138

FIRESTOP COLLAR ENDLESS

0138_01

REV 00

No scale

All units are in millimetres

Fire Rating EI 120 U/U

Comprise concrete, aerated concrete, brickwork, lime malm bricks or masonry. min density of 650 kg/m³

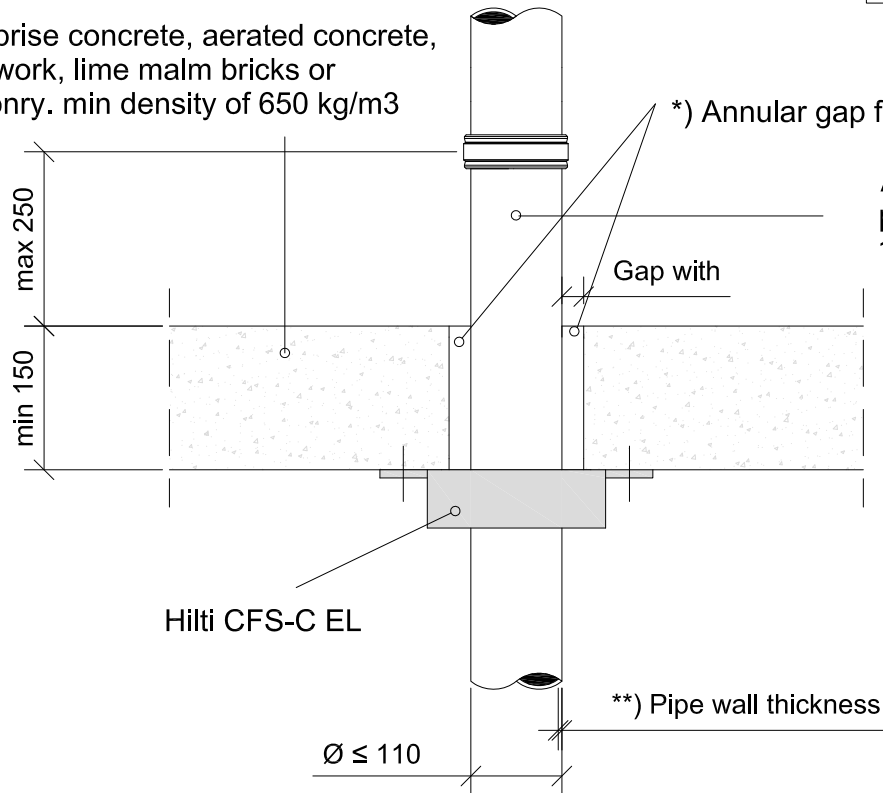

ABS and SAN+PVC pipes acc EN 1519-1, 12666-1 and 12201-2

*) Annular gap fill material

Gap with (mm)	Annular Gap Fill
0-15	Hilti Firestop Acrylic Sealant CFS-S ACR only with a depth > 25 mm on both sides of the floor
0-40	Hilti Firestop Acrylic Sealant CFS-S ACR on top side of floor only with depth > 25 mm, backfilled with mineral wool
0-40	Cementitious mortar acc. EN 998-2 group M10 over the entire thickness of the wall.

- Approval ETA-14/0085 of 23/04/2014
- Reaction to fire acc EN 13501-1
- Fire resistance test acc EN 1366-3
- Installation according to Hilti instructions

**) The pipe wall thickness approved can be found in this graphic

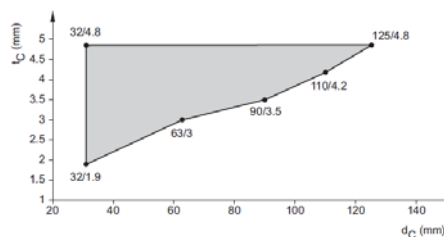
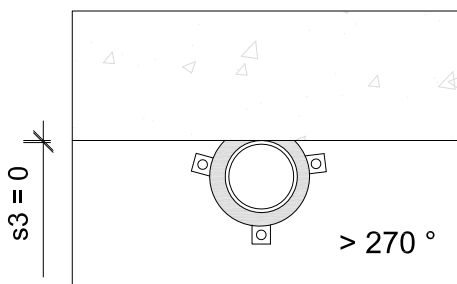



CONTENTS

Plastic pipe on the corner in a rigid floor

ID

IND-RF-PP-0139

FIRESTOP COLLAR ENDLESS

0139_01

REV

00

No scale

All units are in millimetres

Fire Rating EI 90 U/U

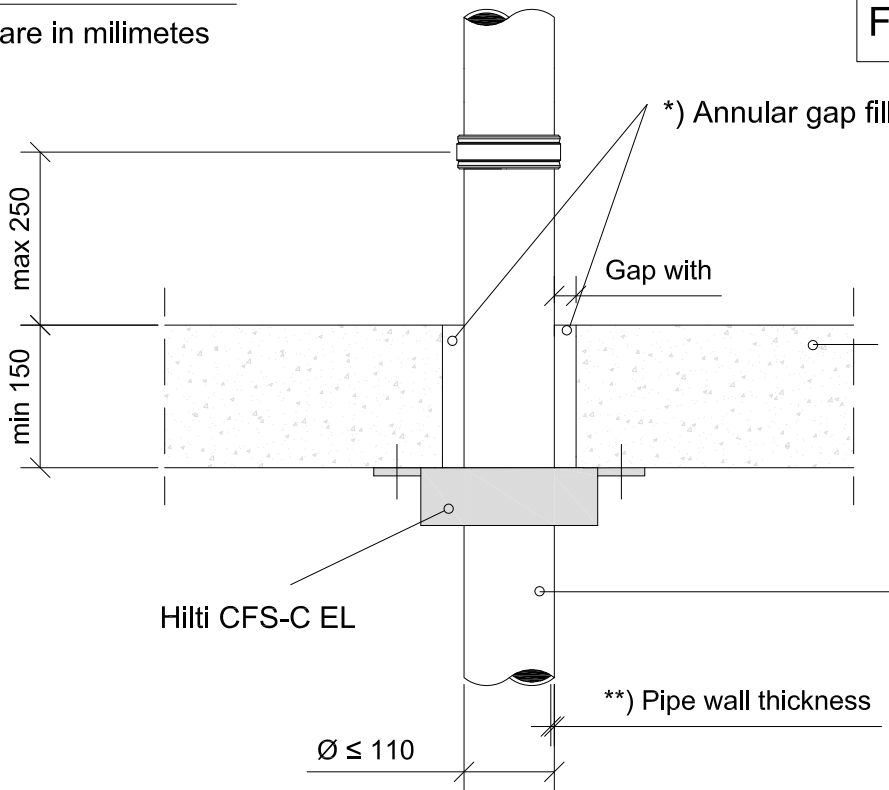

Comprise concrete, aerated concrete, brickwork, lime malm bricks or masonry. min density of 650 kg/m³

ABS and SAN+PVC pipes acc EN 1519-1, 12666-1 and 12201-2

Hilti CFS-C EL

** Pipe wall thickness

$\varnothing \le 110$

*) Annular gap fill material

Gap with (mm)	Annular Gap Fill
0-15	Hilti Firestop Acrylic Sealant CFS-S ACR only with a depth > 25 mm on both sides of the floor
0-40	Hilti Firestop Acrylic Sealant CFS-S ACR on top side of floor only with depth > 25 mm, backfilled with mineral wool
0-40	Cementious mortar acc. EN 998-2 group M10 over the entire thickness of the wall.

- Approval ETA-14/0085 of 23/04/2014
- Reaction to fire acc EN 13501-1
- Fire resistance test acc EN 1366-3
- Installation according to Hilti instructions

** The pipe wall thickness approved can be found in this graphic

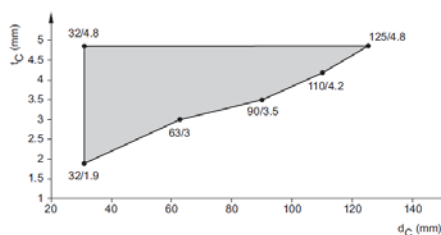
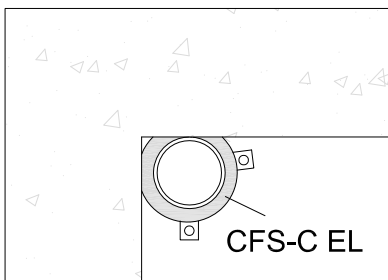



CONTENTS

Plastic pipe junction in floors
(Manifold)

ID

IND-RF-PP-0140

FIRESTOP COLLAR ENDLESS

0140_01

REV

00

No scale

All units are in millimetres

Fire Rating EI 120 U/U

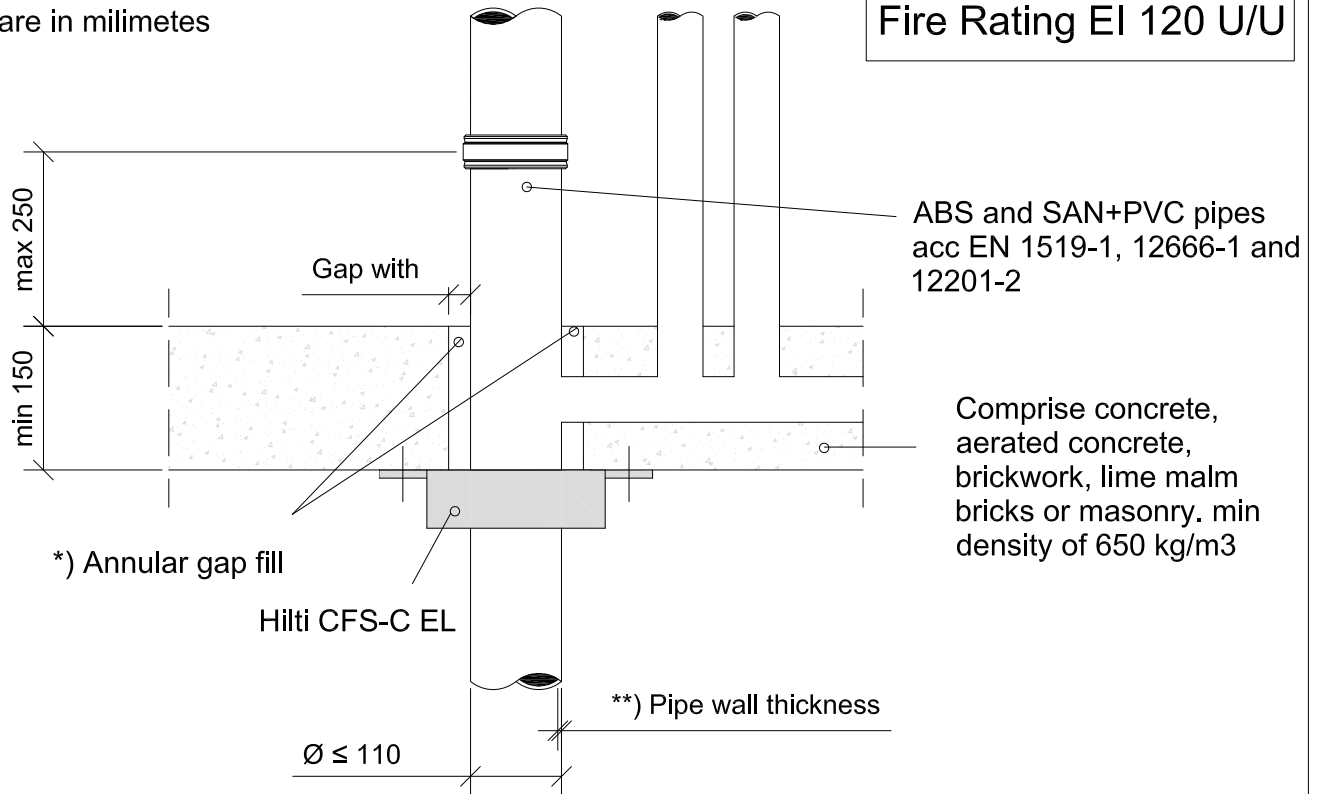

Comprise concrete, aerated concrete, brickwork, lime malm bricks or masonry. min density of 650 kg/m³

*) Annular gap fill

Hilti CFS-C EL

**) Pipe wall thickness

$\varnothing \leq 110$

*) Annular gap fill material

Gap with (mm)	Annular Gap Fill
0-15	Hilti Firestop Acrylic Sealant CFS-S ACR only with a depth > 25 mm on both sides of the floor
0-40	Hilti Firestop Acrylic Sealant CFS-S ACR on top side of floor only with depth > 25 mm, backfilled with mineral wool
0-40	Cementitious mortar acc. EN 998-2 group M10 over the entire thickness of the wall.

- Approval ETA-14/0085
- Reaction to fire acc EN 13501-1
- Fire resistance test acc EN 1366-3
- Installation according to Hilti instructions

DESCRIPTION

Inside the floor there are one or more pipe junctions/manifolds into the central waste water pipe, where horizontal running minor pipes flow to. Those minor pipes have a U/C end configuration and can be installed in line on an unlimited amount. The CFS-C EL shall be installed only on the bottom part of the central waste water pipe.

**) The pipe wall thickness approved can be found in this graphic

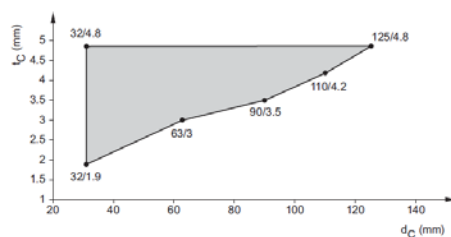



CONTENTS

Plastic pipe junction in floors
(Manifold)

ID

IND-RF-PP-0141

FIRESTOP COLLAR ENDLESS

0141_01

REV

00

No scale

All units are in millimetres

Fire Rating EI 120 U/U

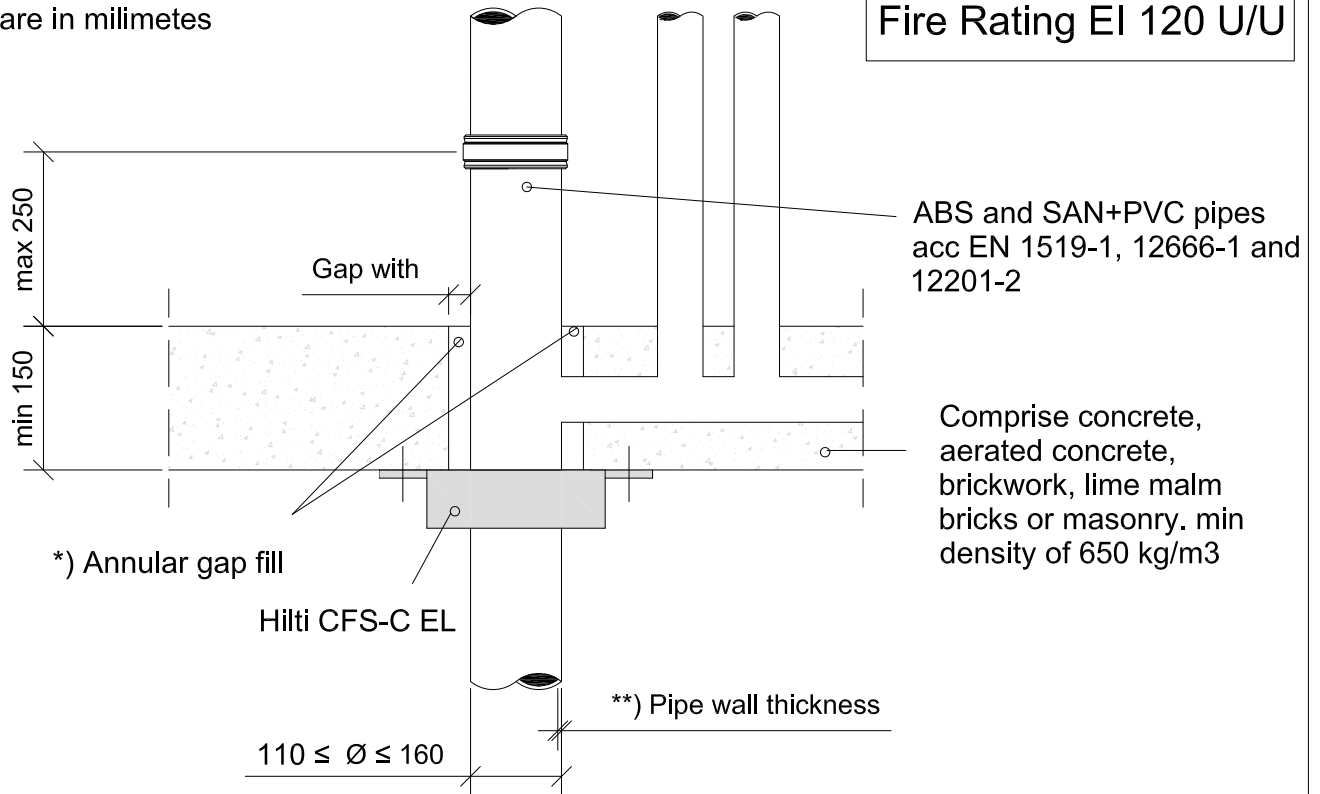

*) Annular gap fill

Hilti CFS-C EL

**) Pipe wall thickness

$110 \leq \varnothing \leq 160$

*) Annular gap fill material

Gap with (mm)	Annular Gap Fill
0-15	Hilti Firestop Acrylic Sealant CFS-S ACR only with a depth > 25 mm on both sides of the floor
0-40	Hilti Firestop Acrylic Sealant CFS-S ACR on top side of floor only with depth > 25 mm, backfilled with mineral wool
0-40	Cementious mortar acc. EN 998-2 group M10 over the entire thickness of the wall.

- Approval ETA-14/0085 of 23/04/2014
- Reaction to fire acc EN 13501-1
- Fire resistance test acc EN 1366-3
- Installation according to Hilti instructions

DESCRIPTION

Inside the floor there are one or more pipe junctions/manifolds into the central waste water pipe, where horizontal running minor pipes flow to. Those minor pipes have a U/C end configuration and can be installed in line on an unlimited amount. The CFS-C EL shall be installed only on the bottom part of the central waste water pipe.

**) The pipe wall thickness approved can be found in this graphic

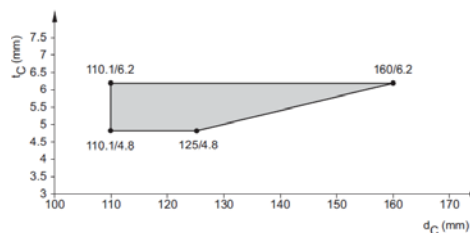



CONTENTS

Plastic pipe junction in floors
(Manifold)

ID

IND-RF-PP-0142

FIRESTOP COLLAR ENDLESS

0142_01

REV

00

No scale

All units are in millimetres

Fire Rating EI 60 U/U

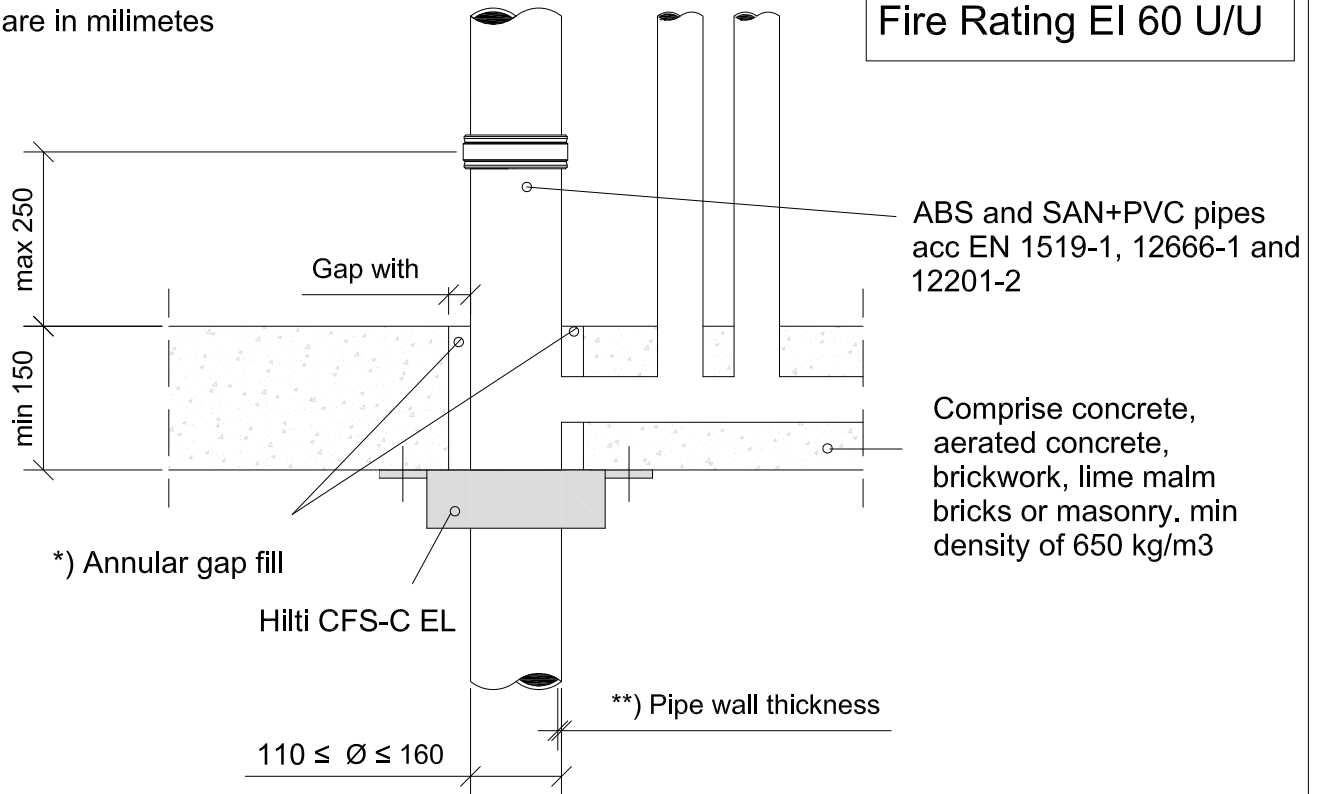

*) Annular gap fill material

Gap with (mm)	Annular Gap Fill
0-15	Hilti Firestop Acrylic Sealant CFS-S ACR only with a depth > 25 mm on both sides of the floor
0-40	Hilti Firestop Acrylic Sealant CFS-S ACR on top side of floor only with depth > 25 mm, backfilled with mineral wool
0-40	Cementitious mortar acc. EN 998-2 group M10 over the entire thickness of the wall.

- Approval ETA-14/0085 of 23/04/2014
- Reaction to fire acc EN 13501-1
- Fire resistance test acc EN 1366-3
- Installation according to Hilti instructions

DESCRIPTION

Inside the floor there are one or more pipe junctions/manifolds into the central waste water pipe, where horizontal running minor pipes flow to. Those minor pipes have a U/C end configuration and can be installed in line on an unlimited amount. The CFS-C EL shall be installed only on the bottom part of the central waste water pipe.

**) The pipe wall thickness approved can be found in this graphic

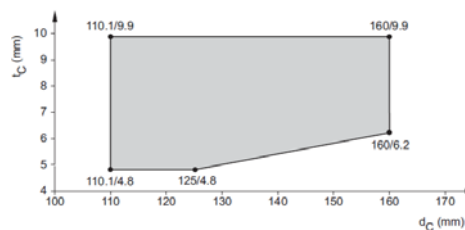



CONTENTS

Zero distance to other system
and Conlit

ID

IND-RF-PP-0147

FIRESTOP COLLAR ENDLESS

0147_01

REV

00

No scale

All units are in millimetres

Fire Rating EI 120 U/U

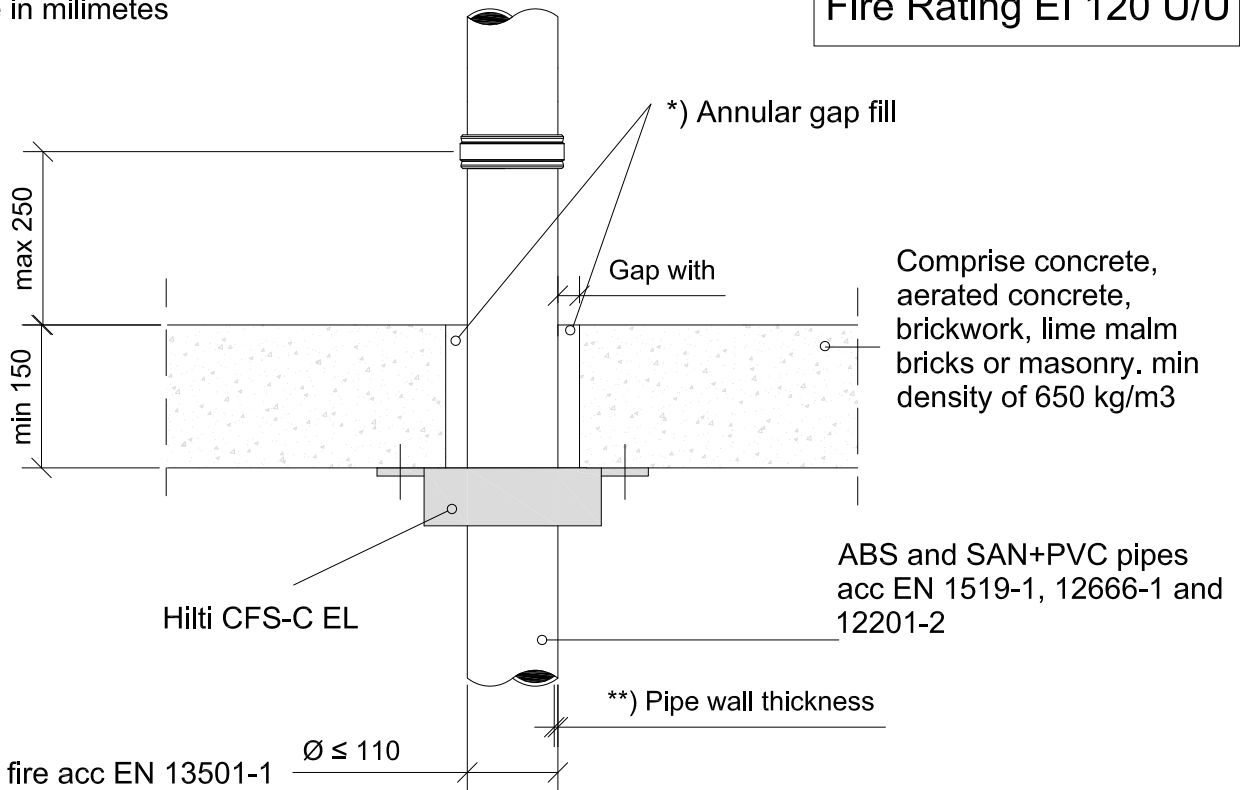

- Reaction to fire acc EN 13501-1
- Fire resistance test acc EN 1366-3
- Installation according to Hilti instructions
- Approval ETA-14/0085 of 23/04/2014

Approved pipes and insulation to be used with Conlit 150, Rockwool 800 and CFS-B

Pipes types	Copper, unalloyed steel, alloyed steel, cast iron, stainless steel
Pipe outside diameter	dm < 42 mm
Pipe thickness	1.2 mm < tm < 14.2 mm
Elastomeric foamed thermal insulation	CS with minimum length (ld>250mm) on both sides of the wall.
Elastomeric foamed thermal insulation thickness	9 mm < De < 35 mm
Incombustible thermal insulation, based on mineral wool (combustibility class A1 or A2 in acc EN 13501	- Conlit 150 inside the wall/floor only with Insulation thickness (td>19 mm) - Rockwool 800, covering the metal pipe outside the wall/floor with Insulation thickness td> 20 mm

*) Annular gap fill material

Gap with (mm)	Annular Gap Fill
0-15	Hilti Firestop Acrylic Sealant CFS-S ACR only with a depth > 25 mm on both sides of the floor
0-40	Hilti Firestop Acrylic Sealant CFS-S ACR on top side of floor only with depth > 25 mm, backfilled with mineral wool
0-40	Cementitious mortar acc. EN 998-2 group M10 over the entire thickness of the wall.

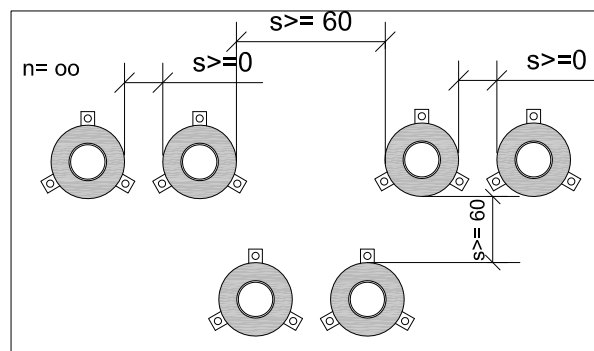

***) The pipe wall thickness approved can be found in this graphic

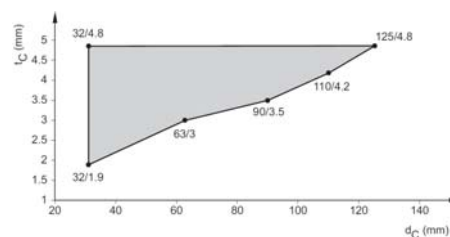



CONTENTS

Zero distance to CFS-B

ID

IND-RF-PP-0148

FIRESTOP COLLAR ENDLESS

0148_01

REV

00

No scale

All units are in millimetres

Fire Rating EI 90 U/U

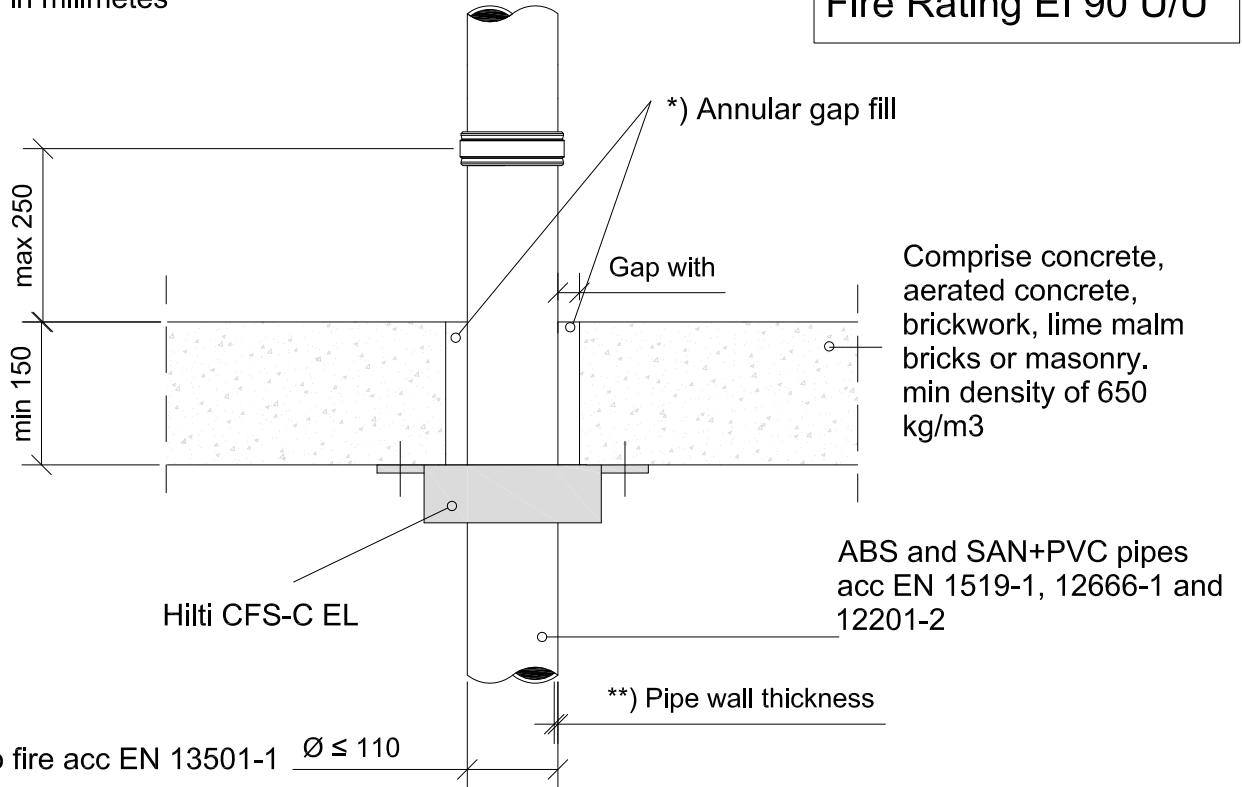

Comprise concrete, aerated concrete, brickwork, lime malm bricks or masonry. min density of 650 kg/m³

ABS and SAN+PVC pipes acc EN 1519-1, 12666-1 and 12201-2

- Reaction to fire acc EN 13501-1 $\text{Ø} \leq 110$
- Fire resistance test acc EN 1366-3
- Installation according to Hilti instructions
- Approval ETA-14/0085 of 23/04/2014

*) Annular gap fill material

Gap with (mm)	Annular Gap Fill
0-15	Hilti Firestop Acrylic Sealant CFS-S ACR only with a depth > 25 mm on both sides of the floor
0-40	Hilti Firestop Acrylic Sealant CFS-S ACR on top side of floor only with depth > 25 mm, backfilled with mineral wool
0-40	Cementitious mortar acc. EN 998-2 group M10 over the entire thickness of the wall.

Approved pipes and insulation to be used with CFS-B

Pipes types	Copper, unalloyed steel, alloyed steel, cast iron, stainless steel
Pipe outside diameter	$d_m < 42 \text{ mm}$
Pipe thickness	$1.2 \text{ mm} < t_m < 14.2 \text{ mm}$
Elastomeric foamed thermal insulation	CS with minimum length ($l_d > 250 \text{ mm}$) on both sides of the floor.
Elastomeric foamed thermal insulation thickness	$9 \text{ mm} < De < 35 \text{ mm}$

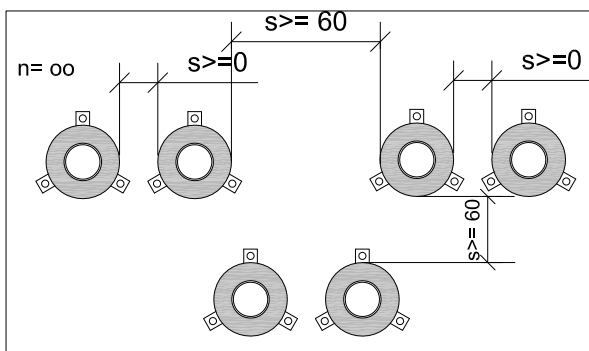

**) The pipe wall thickness approved can be found in this graphic

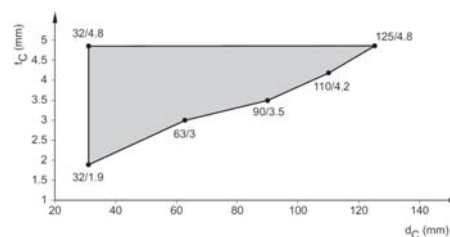



CONTENTS

Zero distance to other system

ID

IND-RF-PP-0149

FIRESTOP COLLAR ENDLESS

0149_01

REV

00

No scale

All units are in millimetres

Fire Rating EI 120 U/U

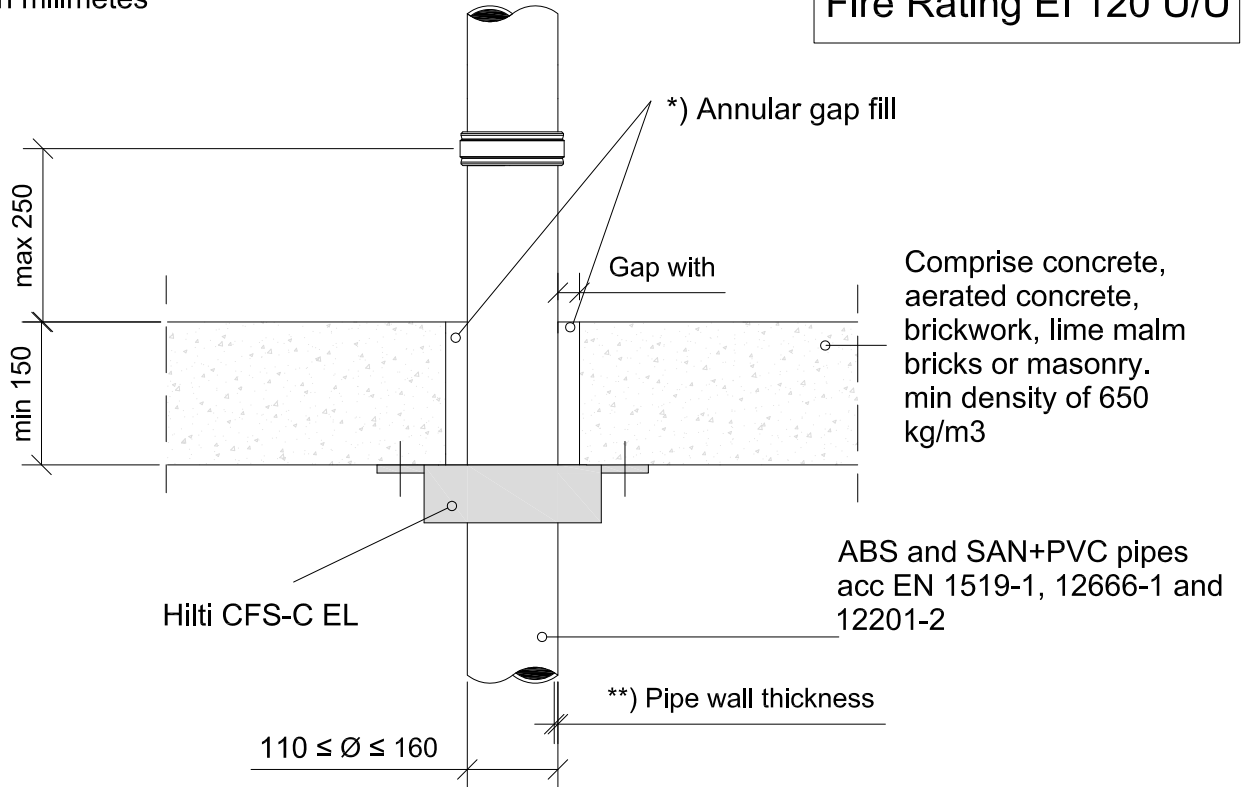

*) Annular gap fill material

Gap with (mm)	Annular Gap Fill
0-15	Hilti Firestop Acrylic Sealant CFS-S ACR only with a depth > 25 mm on both sides of the floor
0-40	Hilti Firestop Acrylic Sealant CFS-S ACR on top side of floor only with depth > 25 mm, backfilled with mineral wool
0-40	Cementious mortar acc. EN 998-2 group M10 over the entire thickness of the wall.

- Approval ETA-14/0085 of 23/04/2014
- Reaction to fire acc EN 13501-1
- Fire resistance test acc EN 1366-3
- Installation according to Hilti instructions

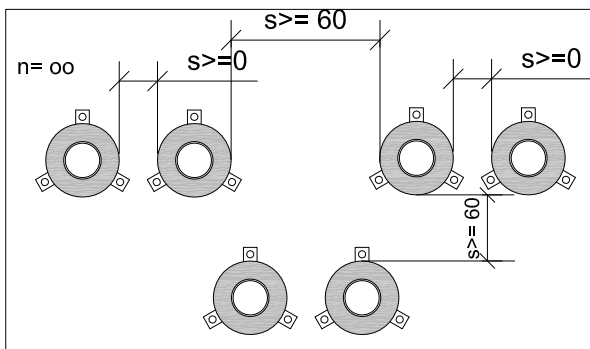

***) The pipe wall thickness approved can be found in this graphic

