

# Schémas d'applications pour la bande CFS-W



## Applications pour eau potable

- |   |                |
|---|----------------|
| • Tube plastique PE-HD en cloison épaisseur 100 mm      | POT-FW-PP-0080 |
| • Tube plastique PE-HD en voile rigide épaisseur 150 mm | POT-RW-PP-0094 |
| • Tube plastique PE-HD en voile rigide épaisseur 100 mm | POT-RW-PP-0095 |
| • Tube plastique PE en dalle rigide épaisseur 100 mm    | POT-RF-PP-0111 |

\*) Tous les schémas sont également disponibles sur demande en format DWG pour faciliter l'insertion sur des plans.



CONTENTS

Straight plastic pipe in a flexible wall

ID

POT-FW-PP-0080

FIRESTOP WRAP

0080\_01

REV

00

No scale

All units are in millimetres

Fire Rating EI 120 U/C

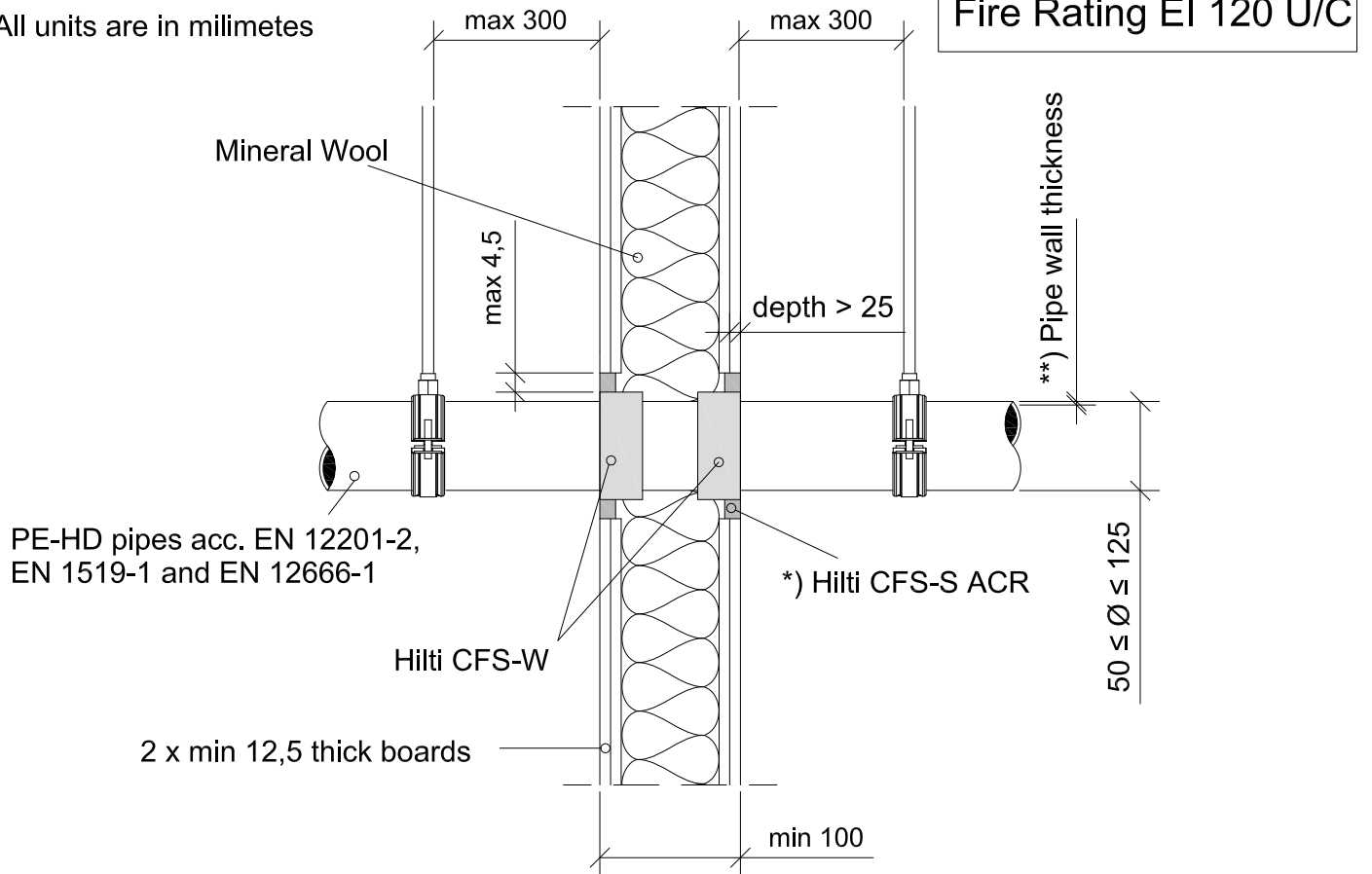

PE-HD pipes acc. EN 12201-2, EN 1519-1 and EN 12666-1

\*) Hilti CFS-S ACR

Hilti CFS-W

2 x min 12,5 thick boards

\*\*.) Pipe wall thickness

50 ≤ Ø ≤ 125

\*) Annular gap fill material

Hilti Firestop Acrylic Sealant CFS-S ACR on both sides with depth > 25 mm from the surface of the wall, backfilled with mineral wool, min 100 kg/m<sup>3</sup> in the gap between the wall lining around the opening with a depth > 100 mm

- Approval ETA-10/0405 of 28/06/2013
- Reaction to fire acc EN 13501-1
- Fire resistance test acc EN 1366-3
- Installation according to Hilti instructions

\*\*.) Pipe wall thickness

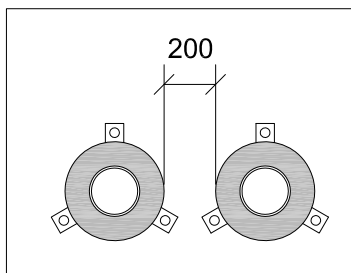

Minimum distance between annular gap

| Pipe diameter | Pipe wall thickness | Type of wrap | Size CFS-W SG<br>n° layers CFS-W EL |
|---------------|---------------------|--------------|-------------------------------------|
| 50            | 3.0                 | CFS-W SG     | 50/1.5"                             |
| 63            | 3.0                 | CFS-W SG     | 63/2"                               |
| 75            | 3.0                 | CFS-W SG     | 75/2.5"                             |
| 90            | 4.8                 | CFS-W SG     | 90/3"                               |
| 90            | 4.8                 | CFS-W SG     | 110/4"                              |
| 110           | 4.8                 | CFS-W SG     | 125/5"                              |
| ≤ 75          | 3.0                 | CFS-W EL     | 1                                   |
| 75 ≤ Ø ≤ 125  | 4.8                 | CFS-W EL     | 2                                   |



CONTENTS

**Straight plastic pipe in a rigid wall**

ID

POT-RW-PP-0094

**FIRESTOP WRAP**

0094\_01

REV

00

No scale

All units are in millimetres

**Fire Rating EI 180 U/C**

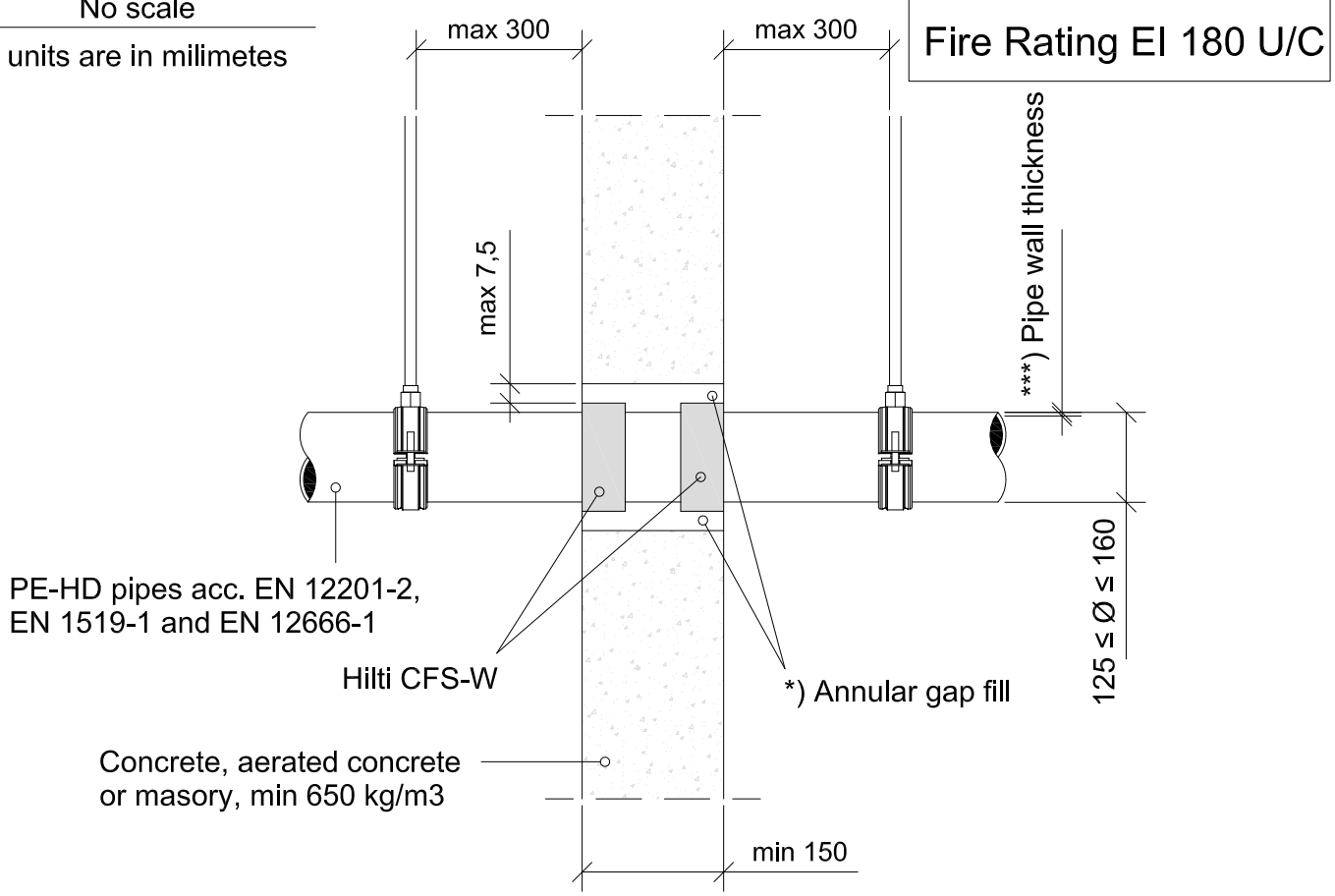

PE-HD pipes acc. EN 12201-2, EN 1519-1 and EN 12666-1

Hilti CFS-W

Concrete, aerated concrete or masonry, min 650 kg/m<sup>3</sup>

\*) Annular gap fill

\*\*\*) Pipe wall thickness

125 ≤ Ø ≤ 160

\*) Annular gap fill material

Hilti Firestop Acrylic Sealant CFS-S ACR on both sides with depth > 15 mm from the surface of the wall, backfilled with mineral wool

Cementitious mortar over the entire thickness of the wall.

\*\*) Pipe wall thickness

| Pipe diameter | Pipe wall thickness | Type of wrap | Size CFS-W SG<br>n° layers CFS-W EL |
|---------------|---------------------|--------------|-------------------------------------|
| 160           | 6.2                 | CFS-W SG     | 160/6"                              |
| 125 ≤ Ø ≤ 160 | 6.2                 | CFS-W EL     | 3                                   |

- Approval ETA-10/0405 of 28/06/2013
- Reaction to fire acc EN 13501-1
- Fire resistance test acc EN 1366-3
- Installation according to Hilti instructions

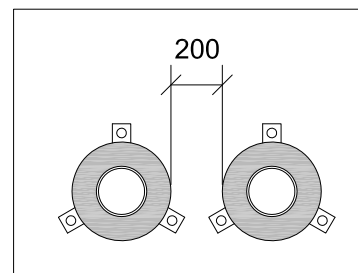

Minimum distance between annular gap



CONTENTS

Straight plastic pipe in a rigid wall

ID

POT-RW-PP-0095

FIRESTOP WRAP

0095\_01

REV

00

No scale

All units are in millimetres

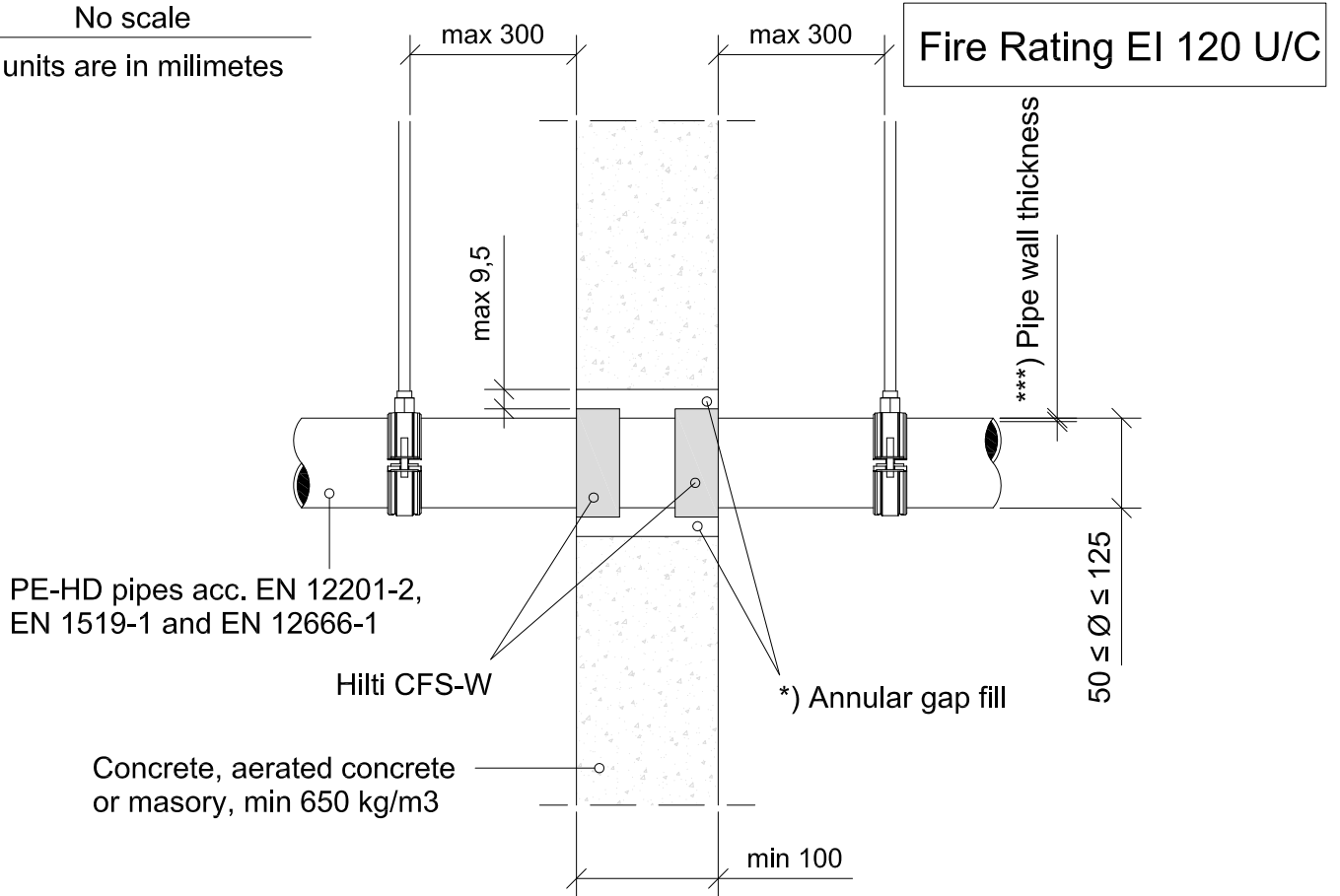

\*) Annular gap fill material

Hilti Firestop Acrylic Sealant CFS-S ACR on both sides with depth > 15 mm from the surface of the wall, backfilled with mineral wool

Cementitious mortar over the entire thickness of the wall.

- Approval ETA-10/0405 of 28/06/2013
- Reaction to fire acc EN 13501-1
- Fire resistance test acc EN 1366-3
- Installation according to Hilti instructions

\*\*) Pipe wall thickness

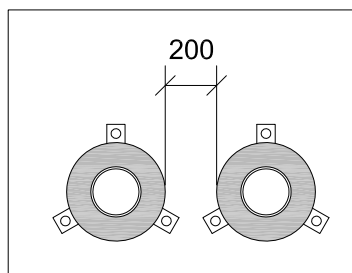

Minimum distance between annular gap

| Pipe diameter | Pipe wall thickness | Type of wrap | Size CFS-W SG<br>n° layers CFS-W EL |
|---------------|---------------------|--------------|-------------------------------------|
| 50            | 3.0                 | CFS-W SG     | 50/1.5"                             |
| 63            | 3.0                 | CFS-W SG     | 63/2"                               |
| 75            | 3.0                 | CFS-W SG     | 75/2.5"                             |
| 90            | 4.8                 | CFS-W SG     | 90/3"                               |
| 90            | 4.8                 | CFS-W SG     | 110/4"                              |
| 110           | 4.8                 | CFS-W SG     | 125/5"                              |
| ≤ 75          | 3.0                 | CFS-W EL     | 1                                   |
| 75 ≤ Ø ≤ 125  | 4.8                 | CFS-W EL     | 2                                   |



CONTENTS

Straight plastic pipe in a floor

ID

POT-RF-PP-0111

FIRESTOP WRAP

0111\_01

REV

00

No scale

All units are in millimetres

Fire Rating EI 120 U/C

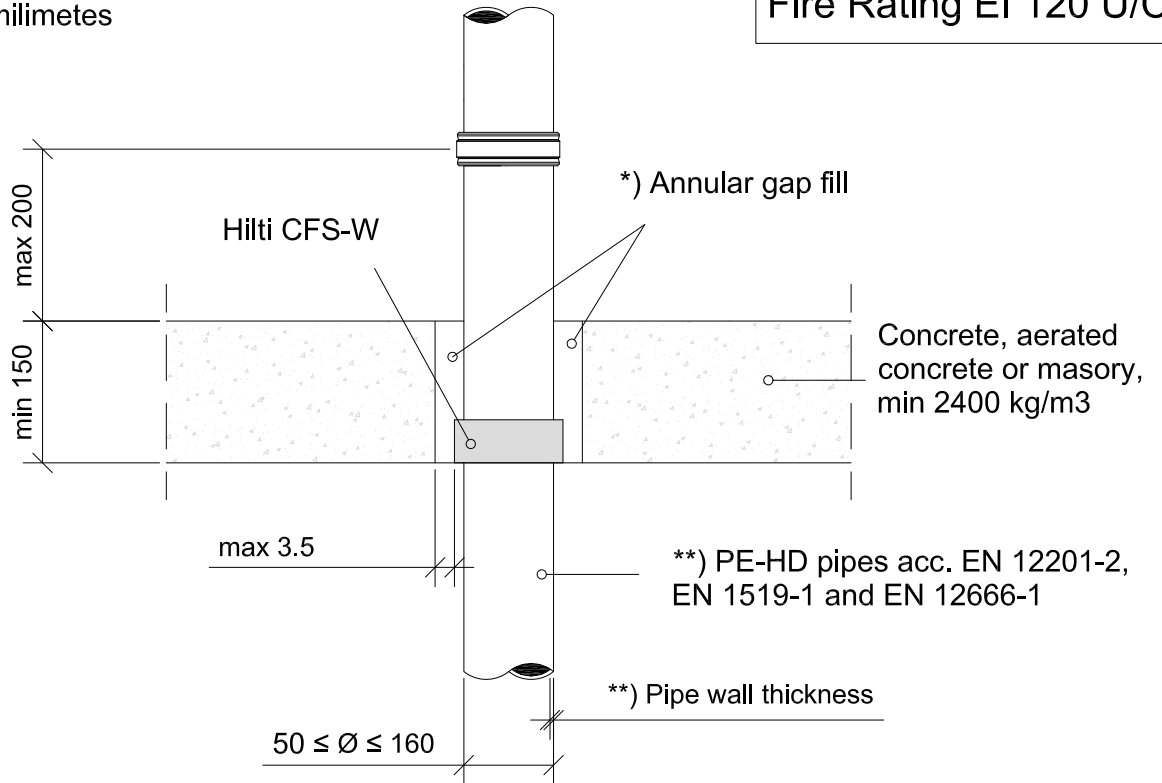

\*) Annular gap fill material

Hilti Firestop Acrylic Sealant CFS-S ACR on both sides with depth > 15 mm from the surface of the wall, backfilled with mineral wool

Cementitious mortar over the entire thickness of the wall.

\*\*) Pipe wall thickness

| Pipe diameter | Pipe wall thickness | Type of wrap | Size CFS-W SG<br>n° layers CFS-W EL |
|---------------|---------------------|--------------|-------------------------------------|
| 50            | 3.0                 | CFS-W SG     | 50/1.5"                             |
| 63            | 3.0                 | CFS-W SG     | 63/2.0"                             |
| 75            | 3.0                 | CFS-W SG     | 75/2.5"                             |
| 90            | 4.8                 | CFS-W SG     | 90/3.0"                             |
| 110           | 4.8                 | CFS-W SG     | 110/4.0"                            |
| 125           | 4.8                 | CFS-W SG     | 125/5.0"                            |
| 160           | 6.2                 | CFS-W SG     | 160/6.0"                            |
| ≤ 75          | 3.0                 | CFS-W EL     | 1                                   |
| 75 ≤ Ø ≤ 125  | 4.8                 | CFS-W EL     | 2                                   |
| 125 ≤ Ø ≤ 160 | 6.2                 | CFS-W EL     | 3                                   |

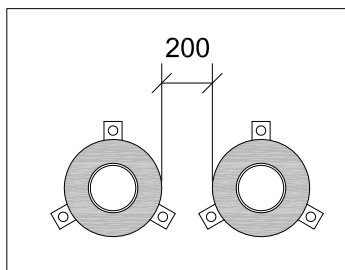

Minimum distance between annular gap

- Approval ETA-10/0405 of 28/06/2013
- Reaction to fire acc EN 13501-1
- Fire resistance test acc EN 1366-3
- Installation according to Hilti instructions